



9th International Conference on **ASIAN MARINE GEOLOGY** **PROGRAM VOLUME**

October 10-12, 2018 | Shanghai, China

MARINE GEOSCIENCE IN RISING ASIA



State Key Laboratory of
Marine Geology, TJU



IODP-China



NSFC (National Natural
Science Foundation of China)

Overview



Meetings, Events & Workshops Overview

Tuesday 9th October

14:00-22:00	Registration	Zhonghe Building
18:30-20:00	Icebreaker Welcome Reception	Sanhaowu Canteen, 2 nd floor

Wednesday 10th October

09:00-12:20	Oral Presentations	Venue 1-5, 7
09:00-12:20	Workshop (W05: Western Pacific)	Venue 6
12:30-13:30	Complimentary Lunch	Xueyuan Canteen, 2 nd floor
14:00-15:30	Workshop (W06: Carbon-cycle)	Venue 5
14:00-15:30	Oral Presentations	Venue 1-4, 6, 7
15:50-16:50	Plenary Talk	129 Hall
16:50-17:50	30 th anniversary of ICAMG	129 Hall
18:00-21:00	Huangpu River Night Cruise Banquet	leaving at the Parking Lot

Thursday 11th October

09:00-12:20	Oral presentations	Venue 1-7
12:30-13:30	Complimentary Lunch	Xueyuan Canteen, 2 nd floor
14:00-15:00	Plenary Talk	129 Hall
15:00-17:50	Poster Session	Zhonghe Building

Friday 12th October

09:00-12:20	Oral presentations	Venue 1-7
12:30-13:30	Complimentary Lunch	Xueyuan Canteen, 2 nd floor
14:00-15:30	Workshop (W04: Scientific Writing)	Venue 7
14:00-15:30	Oral Presentations	Venue 1-6
15:50-16:50	Plenary Talk	129 Hall
16:50-17:50	Closing Ceremony and Awards	129 Hall

* Halal restaurant located in Sanhaowu Canteen 1st floor

Contents

Overview	1
Plenaries	3
Committees	6
Scientific sessions	8
Program at a glance	14
Onsite information	16
Presenter Guidelines	17
Field Excursions	20
Wed. Oral timetable	24
Thu. Oral timetable	46
Fri. Oral timetable	62
Posters sessions	83
Maps	130

ICAMG-9 Welcome

In September 1988, the First International Conference on Asian Marine Geology (ICAMG) was held in Shanghai, China. Since then, the conference has been held almost every four years. The 2nd ICAMG was in Tokyo in 1992; the 3rd in Cheju, Korea in 1996; the 4th in Qingdao, China in 1999; the 5th in Bangkok, Thailand in 2004; the 6th in Kochi, Japan in 2008; the 7th in Goa, India in 2011, and the 8th in Busan, Korea in 2015.

These conferences have given researchers good opportunities to exchange ideas and new information and to plan for future collaboration. The 9th ICAMG will be held in October 10-12, 2018 again in Shanghai.

You are kindly invited to join this event to review the progress of Asian marine geology over the past 30 years, to exchange ideas on new frontier research, and to discuss the perspectives of future development of marine geology.

Plenaries



15:50-16:20 Wed. 129 HALL

Scientific and engineering achievements of the D/V Chikyu - Core-Log-Seismic-Observatory Integration

Asahiko Taira

Japan Agency for Marine- Earth Science & Technology, Japan

Professor in marine geology and geophysics.

President of JAMSTEC, fellow of the GSA and Japan Geoscience Union, winner of Japan Academy Prize.

<http://www.jamstec.go.jp/e/about/foreword/>



16:20-16:50 Wed. 129 HALL

Origin and Evolution of the West Philippine Basin

Brian Taylor

University of Hawai'i at Manoa, USA

Dean, School of Ocean and Earth Science and Technology, University of Hawaii at Manoa.

<https://www.soest.hawaii.edu/soestwp/about/directory/brian-taylor/>



14:00-14:30 Thu. 129 HALL

The Role of Marine Geology in Geoheritage Conservation

Kyung Sik Woo

Kangwon National University, Korea
Professor in geology, geochemistry and
paleoclimatology. Chair of IUCN WCPA
Geoheritage Specialist Group. The former
President of International Union of Speleology.
Email: weeks@kangwon.ac.kr



14:30-15:00 Thu. 129 HALL

A Last Interglacial perspective on future rates of sea-level rise

Eelco J. Rohling

Australian National University, Australia
Professor in oceans and climate change; 2012
Australian Laureate Fellow, associate Director
(research), editor of Reviews of Geophysics.
<http://climate.anu.edu.au/about-us/people/eelco-j-rohling>





15:50-16:20 Fri. 129 HALL

The Role of Aquatic Critical Zones in Coastal Carbon Cycling

Thomas S. Bianchi

University of Florida, USA

Professor in organic geochemistry and marine biogeochemistry. Editor-in Chief of Marine Chemistry, Fellow of the AAAS, Geochemical Society, and European Association of Geochemistry.

<https://geology.ufl.edu/people/faculty/dr-thomas-s-bianchi/>



16:20-16:50 Fri. 129 HALL

Long-term in situ observations of deep-sea sedimentary dynamic processes

Zhifei Liu

Tongji University, China

Professor in marine sedimentology and paleoenvironmental change. Changjiang (Cheung Kong) distinguished professor.

<http://ocean.tongji.edu.cn/space/zhifei/>

Committees



International Committee

Advisors

Pinxian Wang
Asahiko Taira

Tongji University, China
Japan Agency for Marine-Earth Science &
Technology, Japan

Yong Ahn Park

Commission on the Limits of the Continental Shelf,
United Nations

Members

Zhimin Jian
Jiabiao Li

Tongji University, China
Second Institute of Oceanography, State Oceanic
Administration, China

Yoshiki Saito
Shin'ichi Kuramoto

Shimane University, Japan
Japan Agency for Marine-Earth Science &
Technology, Japan

Young Joo Lee

Korea Institute of Geoscience & Mineral
Resources, Korea

Hee Jun Lee
V. Ramaswamy

Korea Institute of Ocean Science & Technology, Korea
National Institute of Oceanography, India

Dhananjai Kumar Pandey

National Center for Antarctic and Ocean
Research, India

Do Huy Cuong

Institute of Marine Geology and Geophysics,
VAS, Vietnam

Thanawat Jarupongsakul
Fernando P. Siringan
V.R. Vijayan

Chulalongkorn University, Thailand
University of the Philippines, Philippines
Minerals and Geosciences Department
Malaysia, Malaysia

Sergey A. Gorbarenko

V.I. Il'ichev Pacific Oceanological Institute, Far-
Eastern Branch of Russian Academy of Science, Russia

Ediar Usman

Research & Development Center for Marine Geology,
Ministry of Mining and Energy, Indonesia



Committees



Organizing Committee

Chair

Shouye Yang Tongji University

Vice chair

Shu Gao East China Normal University/Nanjing University
Xuefa Shi First Institute of Oceanography, State Oceanic
Administration

Members

Nengyou Wu Qingdao Institute of Marine Geology
Jian Lin South China Sea Institute of Oceanology, Chinese Academy of
Sciences
Jingping Xu Southern University of Science and Technology
Xinong Xie China University of Geosciences-Wuhan
Houjie Wang Ocean University of China
Weidong Sun The Institute of Oceanology, Chinese Academy of Sciences
Shiguo Wu Institute of Deep-sea Science and Engineering, Chinese
Academy of Sciences
James T Liu National Sun Yat-sen University
Yongqiang Zong University of Hong Kong

Secretary

Jiubing Cheng Coordinator, Finance
Tel: 86-21-6598 4714 Email: cjb1206@tongji.edu.cn
Hao Cheng Scientific program, Invited talks and Awards
Tel: 86-21-6598 1305 Email: chenghao@tongji.edu.cn
Jin Zhang Exhibition and Sponsorship, Field excursions
Tel: 86-21-6598 5090 Email: mlab@tongji.edu.cn
Xixi Shen Registration
Tel: 86-21-6598 1816 Email: icamg-9@tongji.edu.cn
Jianru Li Logistic support
Tel: 86-21-6598 2588 Email: lijianru@tongji.edu.cn
Tingyu Wen Tel: 86-21-6598 5022 Email: tywen@tongji.edu.cn

Scientific sessions



Workshops

-
- W01** 2nd China-Korea Joint Workshop on Gas Hydrate
Conveners: Nengyou Wu, Dae-Gee Huh
-
- W02** Particle Flux in the Oceans: Recent Progress and Future Perspectives
Conveners: Martin Wiesner, Zhifei Liu, Jianfang Chen, Venu Ittekkot
-
- W03** GeoSummit Workshop on Coastal and Offshore Geology
Conveners: Se Won Chang, Ping Yin, Tomoyuki Sato, Huayan Gan
-
- W04** Preparing, Publishing and Reviewing a Scientific paper or Special Issue
Conveners: Gert J. de Lange, Shu Gao, Chunfeng Li, Zhifei Liu
-
- W05** Mechanisms of the South China Sea formation and ocean drilling
Conveners: Jian Lin, Zhimin Jian
-
- W06** Tropical processes in past global change: hydrology, weathering and carbon-cycle
Conveners: Yair Rosenthal, Enqing Huang, Haowen Dang



Scientific sessions



Theme 1

Coastal and shelf marine geology

-
- S01** [Marine Geology of Islands and Reefs](#)
Conveners: Ying Wang, Chengdong Ge, Kefu Yu
-
- S03** [World's River Deltas: research progress and perspectives](#)
Conveners: Yoshiki Saito, Steve Goodbred, Zhongyuan Chen
-
- S04** [Coastal dynamic and sea level change over time scales](#)
Conveners: Yongqiang Zong, Fengling Yu
-
- S05** [Quaternary shelf sand bodies in Asia and elsewhere: Processes and products](#)
Conveners: Daidu Fan, Serge Berné, Ping Ying, Yoshiki Saito
-
- S06** [Nearshore Dynamic Processes and Hazards under Coastal Storms and Influence of Human Activities](#)
Conveners: Bob Z You, Yongshen Wu, Qinghe Zhang, Jiawen Sun
-
- S08** [Anthropocene Coasts under Global Changes](#)
Conveners: Shu Gao, Ian Townend, Katsuto Uehara, HeeJun Lee
-

Scientific sessions



Theme 2

Source-to-sink study in Asian continental margins

-
- S09** Sediment Gravity Flows: Processes, Products, and Implications to Resource Explorations
Conveners: Jingping Xu, Guangfa Zhong, Xinnong Xie, Shiguo Wu
-
- S10** Sediment Dynamics in the River Plume Regime: Coupling between Physical Process and Geochemical Response
Conveners: James T. Liu, Janping Gan, Hui Wu, Daidu Fan
-
- S11** Interaction of tectonic-climate change with weathering and erosion processes in Asian continental margin
Conveners: Peter Clift, Christian France-Lanord, Shiming Wan
-
- S12** Sediment source-to-sink processes and environmental records in Asian continental margins
Conveners: Xuefa Shi, Steven Kuehl, Dhong-Il Lim, Shouye Yang, Sergey Gorbarenko
-
- S14** When and how clastic detritus are transported from shelf-edge staging areas into deep-water areas: From a source-to-sink perspective
Conveners: Chenglin Gong, Ronald J. Steel, Changsong Lin
-
- S15** Deep-Sea Sedimentary Processes: from Observations to Geological Records
Conveners: Zhifei Liu, Benjamin Kneller, Gert J. de Lange, Yanwei Zhang



Scientific sessions



Theme 3

Paleoceanography and paleoenvironmental changes

-
- S16** Neogene Paleoceanographic and Paleoclimate Variability in the Indo-Pacific Warm Pool
Conveners: Yair Rosenthal, Jun Tian, Haowen Dang
-
- S17** Late Cenozoic ocean circulation, carbon cycle, and climate change in the western Pacific marginal seas
Conveners: Jun Tian, Jimin Yu, Zhonghui Liu
-
- S18** Burial of organic carbon in the coastal margin under a changing world
Conveners: Limin Hu, Peng Yao, Thomas S. Bianchi
-
- S19** Paleoceanographic and climatic evolution and variability recorded in marginal and deep-sea western Pacific sediments; linking land-ocean in present and past
Conveners: Gert J de Lange, Michael Sarnthein, Zhimin Jian
-
- S21** Low latitude Indo-Pacific marginal seas: variabilities in paleoclimatology and paleoceanography and their implications
Conveners: Sanmin Hyun, Rina Zurida
-
- S22** Land-sea interaction processes and paleoenvironmental evolution in the joining area of Indian-Pacific Ocean
Conveners: Che Abd. Rahim Bin Mohamed, Shengfa Liu, Rina Zuraida, Narumol Kornkanitnan
-

Scientific sessions



Theme 4

Marine tectonics, geophysics and geohazards

S23 [Structure, magmatism and dynamics of marginal seas in Western Pacific](#)
Conveners: Tianyao Hao, Sanzhong Li, Weiwei Ding, Zhen Sun

S24 [Seafloor sediment acoustics](#)
Conveners: Baohua Liu, Gil Young Kim, Guangming Kan, Guanbao Li

S25 [Seafloor Failures: Triggering Mechanisms, Processes and Sedimentological Records](#)
Conveners: Chih-Chieh Su, Jing-Yi Lin, Yi-Ching Yeh, Ho-Han Hsu

S26 [Marine Geohazards](#)
Conveners: Yu Huang, Wuwei Mao

Theme 5

Submarine resources

S27 [Advances in natural hydrate systems and methane seeps in marine settings](#)
Conveners: Dong Feng, Min Luo, Xiqiu Han, Haibin Song

S28 [Seabed Mineral Resources: Recent Achievements and Challenges](#)
Conveners: Sang-Joon Pak, Wonnyon Kim, Jonguk Kim



Scientific sessions



Theme 6

Climate changes in Polar regions

-
- S29** [Arctic gateway connecting the North Atlantic and North Pacific Oceans](#)
Conveners: Rujian Wang, Leonid Polyak, Seung-Il Nam, Masanobu Yamamoto

Theme 7

The 50 years of Ocean Drilling and Asian Marine Geology

-
- S30** [The 50 years of Ocean Drilling and Asian Marine Geology](#)
Conveners: Yasuhiro Yamada, Gil Young Kim, Zhimin Jian

General session

-
- S32** [General sessions](#)



Program at a Glance



		Wednesday 10 th	Thursday 11 th	Friday 12 th
09:00-10:30	Venue 1	S10 a	S27 a	S26
	Venue 2	S01 a	S03 a	W05
	Venue 3	S12 a	S19 a	S18 a
	Venue 4	S16	S11 a	S15 & W02 a
	Venue 5	S05 a	W01 a	W03 a
	Venue 6	S30 a	S23 a	S09 & S14 a
	Venue 7	S29 a	S06 a	S06 c
10:30-10:50	Tea Break			
10:50-12:20	Venue 1	S10 b	S27 b	S04 a
	Venue 2	S01 b	S03 b	
	Venue 3	S12 b	S19 b	S18 b
	Venue 4	S17 a	S11 b	S15 & W02 b
	Venue 5	S05 b	W01 b	W03 b
	Venue 6	S30 b	S23 b	S09 & S14 b
	Venue 7	S29 b	S06 b	S32
12:30-14:00	Lunch (Xueyuan Canteen, Sanhaowu Canteen) and Posters			

Wednesday 10 th			Thursday 11 th		Friday 12 th
14:00-15:30	Venue 1	S28	14:00-14:30	Plenary Talk (KyungSik WOO) 129 Hall	S04 b
	Venue 2	S22			S21
	Venue 3	S12 c	14:30-15:00	Plenary Talk (Eelco J. Rohling) 129 Hall	S24
	Venue 4	S17 b			S15 & W02 c
	Venue 5	W06			S25
	Venue 6	S08	Poster Session (Ground floor, Zhonghe Building)	S09 & S14 c	
	Venue 7	S29 c		W04	
15:30-15:50 Tea Break				Tea Break	
15:50-16:20				Plenary Talk (Thomas S. Bianchi)	
16:20-16:50	129 Hall	Plenary Talk (Zhifei Liu)			
16:50-17:50	30 th anniversary of ICAMG			Closing Ceremony and Awards	

Palette

Theme 1 Coastal and shelf marine geology: Sessions 1-8	Theme 4 Marine tectonics, geophysics & geohazards: Sessions 23-26	Theme 7 The 50 years of Ocean Drilling and Asian Marine Geology: Session 30
Theme 2 Source-to-sink study in Asian continental margins: Sessions 9-15	Theme 5 Submarine resources: Sessions 27, 28	General Session 32 & 31,20,13,7,2
Theme 3 Paleooceanography and paleoenvironmental changes: Sessions 16-22	Theme 6 Climate changes in Polar regions: Session 29	Workshops W01-06

Onsite Information



Conference Rooms

Registration, posters, the exhibition and refreshments are located in the Zhonghe Building. Oral sessions will take place in rooms in the Sino-France Center and the Yifu Building. Plenary sessions will take place in 129 Hall. A map of the conference rooms can be found at the back of this handbook.



Registration & Help Desk Opening Times

Registration and the Help Desk will be open in the Zhonghe Building on the first floor from 14:00-22:00 on Tuesday (9th) and 09:00-17:50 on Wednesday (10th), Thursday (11th) and Friday (12th).



Refreshments & Breaks

These will be available in the Sino-France Center, the Yifu Building and the Zhonghe Building during the times allocated for oral presentations. Refreshments will also be available during the poster sessions on Thursday (11th).



Wireless Internet Access

All delegates may access the wireless internet on campus. Login details will be provided on registration desk.



Name Badges

Claim your name badge on the Registration desk. Please be sure to wear your name badge at all times.



Lost and Found

All items found in the relevant conference rooms should be brought to the Help Desk.

Smoking Policy

All rooms used by the conference have been designated as non-smoking areas.

Mobile Phones, Cameras and Video Cameras

Delegates are required to mute or turn off their cell phones during oral presentations. No photography or videoing is permitted in any of the oral and poster sessions. Please also respect the wishes of presenters who prefer that their results are not published on social media.



Presenter Guidelines



Oral Presentation

Presentation Times and Locations

Oral presentations in 32 sessions will take place in seven venues located in Zhonghe Building, Yifu Building, Sino-France Center, and 129 Hall in time ranges of 9:00-10:30, 10:50-12:20, and 14:00-15:30 every day from 10th to 12th October, 2018. Please find your presenting time range and venue in the brochure.

Prepare your presentation

The presenters may prepare your presentation using various software, however, we suggest to save your presentations in Microsoft PowerPoint on Windows (*.pptx) or Adobe Reader (*.pdf) in order to display the presentation correctly and smoothly. The slides are suggested to be in landscape orientation with aspect ratio of 4:3 to have an optimum use of the screen. The major body of the presentation should be in English.

Upload your presentation

We strongly suggest the presenters to upload your presentations at the ground floor of the Zhonghe Building at least 6 hours before the start of the presenting session that you are assigned in. When you upload your presentation, please remind our staff to go over the presentation to make sure that all fonts and pictures appear as designed. If there is audio/video in the presentation, please inform our staff.

If the presenters cannot upload the presentation 6 hours before the start of the session or if revision is made on the presentation that has been uploaded, the presenter should upload your presentation in the venue no less than 30 minutes

Presenter Guidelines



Oral presentation

before the start of the first presentation in your session.

We also suggest the presenter bring a copy of your presentation file using a USB flash drive to the venue in case there is an issue with your uploaded file.

Presentation Timing

The presenter should arrive at the venue at least 15 minutes before the start of the first presentation to meet with the convener. The time limit for regular presentation is 15 minutes, we suggest the presenter finish your talk after 12 minutes to leave time for discussion. The convener will give signals after 10 and 12 minutes, and prevent further talking after 15 minutes. The presentation should be given in English.

* NO PHOTOGRAPHY OR VIDEOING IS PERMITTED IN ANY OF THE ORAL PRESENTATIONS.



Presenter Guidelines



Poster Presentation

Poster session is scheduled from 15:00 to 17:50 on Thursday (11th) at the ground floor of the Zhonghe Building.

The Best Student Poster Award will be given in recognition of the Best Student Poster presented at the conference.

Prepare your poster

An A0 size poster in portrait orientation (841 mm wide by 1189 mm tall) would fit the poster board perfectly. So please make your poster size, especially the width be in this limit. The major body of the poster should be in English, and the presenter's name should be underlined.

Poster setup

Each poster is assigned with a poster ID, for example S01-P01-A0001, which can be found in the brochure, and will be marked on the poster board as well. The presenters are suggested to set up their poster at the assigned board as early as possible so that the conference attendee would have enough time to read your work, but are requested to be no later than the start of the Poster Session (15:00-17:50 on Thursday at the ground floor of Zhonghe Building). During the poster session, all the presenters are expected to be available by their poster for discussion. The presenter might also should put a card to indicate other time ranges to be present. The posters should be removed by 6:00 pm on Friday (12th October, 2018).

Poster printing

We do not provide on-site poster printing service, but there are places on and off campus where you can print posters. Please refer to the guideline map or find assistance from our volunteers.

Field Excursions

Pre-conference



Chongming Island and National Wetland Park in the Changjiang Delta

Fieldtrip Leaders:

Prof. Daidu Fan and Dr. Hang Gao
(Tongji University)

Dates: October 9, 2018

Transportation: Bus



Schedule (October 9, 2018)

7:30 am

Depart by bus from Magnolia Hotel

STOP 1

Changxing Island for Qingcaosha Freshwater Reservoir (the largest estuarine typed freshwater reservoir in the world), onshore wind power tower, the first Changjiang Bridge across the North Channel.

STOP 2:

Dongtan National Park for Yangtze alligator, migratory bird museum, and saltmarsh plants and ecology. Lunch time, high tide will occur at 11: 00 am

STOP 3:

Dongtan tidal flat for morphology and sedimentology of saltmarsh, and bare flat, and tidal-creek-channel system.

17:30 pm

Depart from Chongming Island and return to Magnolia Hotel



Field Excursions

Post-conference



Birth of the upper Yangtze: Tibet uplift plus Asian monsoon revealed by Cenozoic sediments, Yunnan Province

Fieldtrip Leaders:

Prof. Hongbo Zheng (Yunnan University), Prof. Shouye Yang (Tongji University)

Duration: October 13-17, 2018



Description

As an important border province of southwest China, Yunnan has long been reputed as 'the South of Colored Clouds', offering a large variety of scenic attractions. It has an average altitude of 2,000 meters and a temperate tropical plateau monsoon climate. Geologically, Yunnan is located in the southeastern margin of Tibetan Plateau. Such a location endows Yunnan with a unique natural laboratory for Earth System Science studies, with the most classic geological sites including 'Life Explosion' in early Cambrian in Chengjiang, 'Life Extinction' around Permian/Triassic boundary, dinosaur flourishing during Jurassic, and biodiversity and tectonic geomorphology during the Cenozoic.

Large river systems are an integral and essential component of Earth dynamics. The development of large river systems in Asia is closely linked to the evolving topography driven by both near-field and far-field effects of the interplay among Indian, Eurasian

Field Excursions

Post-conference



and Pacific plates. Plate tectonics together with climatic changes during the Cenozoic are therefore believed to have determined the evolution of Asian large rivers, yet the age of the Yangtze, the largest in Asia, has been strongly debated over a century. This field excursion aims to examine the Cenozoic sequences preserved in Jianchuan Basin, NW Yunnan, and explores its implications on tectonics, geomorphological evolution, possible lineage with proto-Jinshajiang river, and paleoclimatic changes.



-- Restoration Image of the Chengjiang Fauna

Schedule

Day 1 (October 13)

Morning, from Shanghai to Kunming by flight.

Afternoon, Chengjiang Fauna and Yunnan University.

Day 2 (October 14)

Morning, Kunming to Lijiang by flight.

Afternoon, Drive to Liming, observe Cenozoic sequences; Stay in Liming.

Day 3 (October 15)

Morning, Liming to Shigu (First Bend).

Afternoon, Tiger Leaping Gorge.

Night, Stay in Lijiang.

Day 4 (October 16)

Morning, Drive to Jianchuan to observe Cenozoic sequences.

Afternoon, visit Lijiang ancient city.

Night, stay in Lijiang

Day 5 (October 17)

Depart for Shanghai by flight.



Cutline

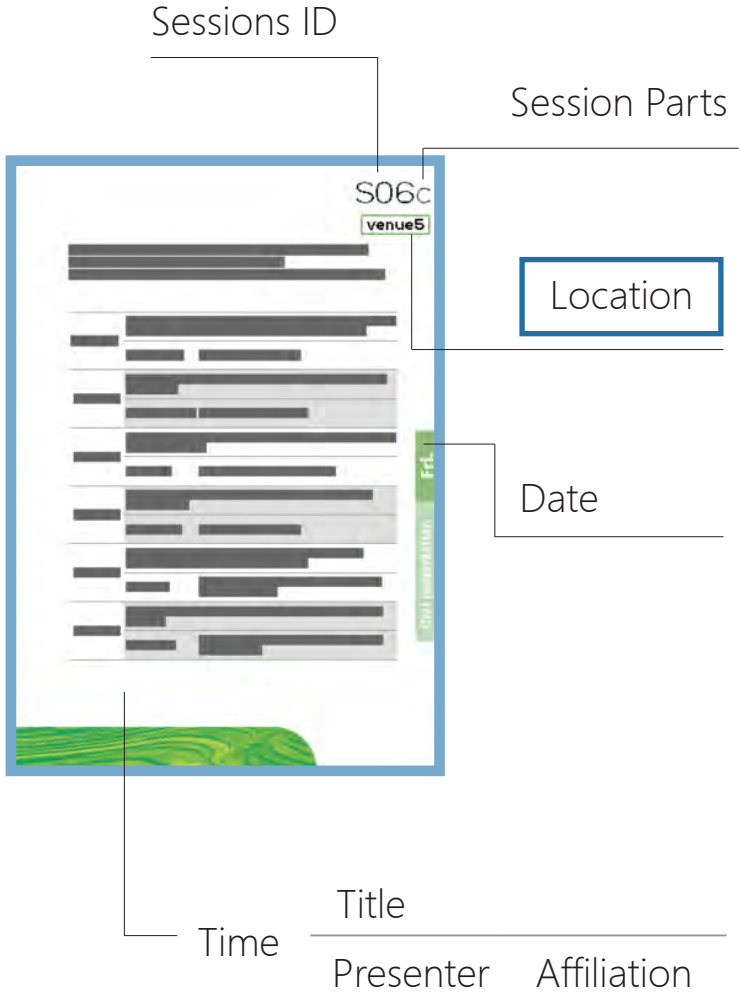

Sediment Dynamics in the River Plume Regime: Coupling between Physical Process and Geochemical Response

Conveners: James T. Liu, Janping Gan, Hui Wu, Daidu Fan

Wed. Oral presentation	09:00-09:15	Buoyant coastal current in a tidal coastal ocean	Hui Wu	East China Normal University, China
	09:15-09:30	Hyperpycnal plume at the Yellow River Mouth triggered by dam regulation: In-situ observations	Houjie Wang	Ocean University of China
	09:30-09:45	Water mass variability in the coupling between physics and suspended par-ticle dynamics along the pathway of Pearl River plume	Jay Lee	National Sun Yat-sen University, Taiwan, China
	09:45-10:00	Seasonal transportation and deposition of the suspended sediments in the Bohai Sea and Yellow Sea and the related mechanisms	Nan Wang	Ocean University of China
	10:00-10:15	The distribution of age in a coastal river plume	Yeping Yuan	Zhejiang University, China
	10:15-10:30	Role of hydrodynamics and sediment on the eutrophication and hypoxia off Pearl River Estuary	Jianping Gan	Hong Kong University of Science and Technology, Hong Kong, China



Marine Geology of Islands and Reefs

Conveners: Ying Wang, Chengdong Ge, Kefu Yu

09:00-09:15	Ecological Progress of modern Coral reefs in the south china sea	
	Kefu Yu	Guangxi University, China
09:15-09:30	Preliminary study of the source apportionment and diversity of microplastics: taking floating microplastics in the South China Sea as an example	
	Teng Wang	Nanjing University, China
09:30-09:45	Carbon, Nitrogen geochemical characteristics and their implications on environmental change in the lagoon sediments of the Dongdao Island of Xisha Islands in South China Sea	
	Chendong Ge	Nanjing University, China
09:45-10:00	Distribution of suspended sediment nearby Nansha Islands in the South China Sea observed from satellite	
	Danling Tang	South China Sea Institute of Oceanology, Chinese Academy of Sciences, China
10:00-10:15	Geo-environmental Degradation of the St. Martin's Island, Bangladesh	
	M.D. Shamsuzzaman	Geological Survey of Bangladesh, Bangladesh
10:15-10:30	Shallow seismic profiles and geomorphology of Daoming and Zhenghe reefs in the northern part of Nansha Islands	
	Xindi Hu	Nanjing University, China

Wed.

Oral presentation



Sediment source-to-sink processes and environmental records in Asian continental margins

Conveners: Xuefa Shi, Steven Kuehl, Dhong-Il Lim, Shouye Yang, Sergey Gorbarenko

09:00-09:15	<p>Role of the East Korean Warm Current to the Holocene sedimentation in the Hupo Trough of the southwestern East Sea</p> <p>Boo-Keun Khim Pusan National University, Korea</p>
09:15-09:30	<p>Clay mineral evolution in the central Okinawa Trough during the past 300 ka: sediment provenance and paleoenvironmental change</p> <p>Yanguang Dou China Geological Survey, China</p>
09:30-09:45	<p>Along-shore and Cross-shore Clinoforms Developed Over The River-Dominated Asian Margins</p> <p>Paul Liu North Carolina State University, USA</p>
09:45-10:00	<p>Suspended sediment distribution and its response to the Cold Water Mass evolution in the southern Yellow Sea</p> <p>Yi Zhong Ocean University of China</p>
10:00-10:15	<p>New insights on the sediments exchange through the Bohai Strait</p> <p>Xiao Wu Ocean University of China, China</p>
10:15-10:30	<p>Source-to-Sink process study on the Asian Continental Margin: characteristics, processes and controlling mechanisms</p> <p>Xuefa Shi First Institute of Oceanography, China</p>



Neogene Paleooceanographic and Paleoclimate Variability in the Indo-Pacific Warm Pool

Conveners: Yair Rosenthal, Jun Tian, Haowen Dang

09:00-09:15	Two Anomalous Modes of the Precessional Modulated Annual Cycle in the Tropical Pacific
	Yue Wang Tongji University, China
09:15-09:30	Indian Monsoon during last 30ka
	Hucai Zhang Yunnan University, China
09:30-09:45	Pleistocene climate variability in the heart of the Western Pacific Warm Pool
	Yair Rosenthal Rutgers University, USA
09:45-10:00	Neogene sea surface temperature of the Western Pacific Warm Pool
	Xiaoqing Liu Texas A&M University, USA
10:00-10:10	Characteristics and significance of trace fossils in the Late Miocene deep-sea volcanoclastic sediments in the Central Basin of the South China Sea
	Pingyuan Li Guangzhou Marine Geological Survey, China
10:10-10:20	Mahanadi River soil organic matter discharge during the last 700 ka in Site U1446, Indian margin of the Bay of Bengal
	Masanobu Yamamoto Hokkaido University, Japan
10:20-10:30	Late Quaternary Coccolith Records in Maldives: records from the IODP Site U1467
	Xiang Su South China Sea Institute of Oceanology, China

Wed.

Oral presentation

Quaternary shelf sand bodies in Asia and elsewhere: Processes and products

Co-chairs: Yoshiki Saito, Ping Yin;

Wed.

Oral presentation

09:00-09:15	Sand bodies as dipsticks of sea-level changes during the Quaternary: East China Sea and elsewhere	Serge Berné	Universit de Perpignan, France
09:15-09:30	Formation of the Yangtze Shoal in response to the stepwise postglacial transgression in the paleo-Yangtze (Changjiang) estuary	Jian Liu	Qingdao Institute of Marine Geology, China
09:30-09:45	Late Quaternary stratigraphic evolution on the outer shelf of the East China Sea	Zhongbo Wang	Qingdao Institute of Marine Geology, China
09:45-10:00	Characteristics and Provenances of Holocene sediments in the the inner shelf of the East China Sea	Qi Li	China University of Geosciences, China
10:00-10:15	Distribution and morphological characterristics of low-angle dunes on a sand ridge off Jiangsu Coast, China	Li Wang	Nanjing University, China
10:15-10:30	Research on stability of sand ridges on the East China Sea shelf—Taking XIHU sag area as example	Yongfu Sun	First Institute of Oceanography, China



The 50 years of Ocean Drilling and Asian Marine Geology

Conveners: Yasuhiro Yamada, Gil Young Kim, Zhimin Jian

09:00-09:15	Obtaining keys to understanding earthquake generation by ocean drilling	
	Kiyoshi Suyehiro	Japan Agency for Marine-Earth Science and Technology
09:15-09:30	Explosive volcanism in the North Bismarck microplate, South Pacific Ocean	
	Jong-Hwa Chun	Korea Institute of Geoscience and Mineral Resources
09:30-09:45	Regional stratigraphic framework of National Gas Hydrate Program Expedition 02 (NGHP-02) Area-B, offshore eastern India	
	Kan-Hsi Hsiung	Japan Agency for Marine-Earth Science and Technology
09:45-10:00	The Japan Sea as an ideal basin for paleo-mass flux study: an example of carbon sequestration rate and efficiency	
	Ryuji Tada	University of Tokyo, Japan
10:00-10:15	Paleoclimate and oceanographic changes during the Plio-Pleistocene climate transition inferred from playnofloras in the Eastern South Korea Plateau (ESKP), East Sea: a preliminary result	
	Yongmi Kim	University of Science and Technology, Korea
10:15-10:30	Evidence of loess transportation during the MIS22 glaciations into Japan Sea/East Sea and implications for the mid-Pleistocene climate transition	
	Maria-Angela Bassetti	Centre of Education and Research on Mediterranean Environments, France

Wed.

Oral presentation

Arctic gateway connecting the North Atlantic and North Pacific Oceans

Conveners: Rujian Wang, Leonid Polyak, Seung-Il Nam, Masanobu Yamamoto

Wed. Oral presentation	09:00-09:15	New paleoceanographic insights on the Arctic-Pacific gateway: from early Pliocene to modern interactions	
		Leonid Polyak	Ohio State University, USA
	09:15-09:30	Late Quaternary depositional and glacial history of the Arliss Plateau off the East Siberian margin, western Arctic Ocean	
		Young Jin Joe	Korea Polar Research Institute, Korea
	09:30-09:45	Pleistocene cyclostratigraphy of sedimentary manganese in the western Arctic Ocean and implications for the North American glacial history	
		Kwangkyu Park	Korea Polar Research Institute, Korea
	09:45-10:00	Western Arctic paleoceanographic changes across the Mid-Bruhnes Event	
		Wenshen Xiao	Tongji University, China
	10:00-10:15	^{230}Th and ^{231}Pa as tracers of Arctic marine particle flux: implications for middle-late Quaternary glacial history	
		Qian Xu	The University of Hong Kong, Hong Kong, China
	10:15-10:30	Reconstruction of the Western Arctic Ocean water stratification over the last 50,000 years	
		Ho Lai Hilary Man	The University of Hong Kong, Hong Kong, China



Sediment Dynamics in the River Plume Regime: Coupling between Physical Process and Geochemical Response

Conveners: James T. Liu, Janping Gan, Hui Wu, Daidu Fan

10:50-11:05	Suspended Sediment Dynamics Related to the River Plume: Coupling between Physics and Biogeochemistry
	James T. Liu National Sun Yat-sen University, Taiwan, China
11:05-11:20	Estimating effective density of cohesive sediment using shape factors from holographic images
	Sunmin Choi Inha University, Korea
11:20-11:35	Differential response of suspended sediment to the hydrodynamics at the confluence of a river and submarine canyon
	Xiaoqin Du National Sun Yat-sen University, Taiwan, China
11:35-11:50	The Spatial-temporal Differentiation of Deposition Centre and Its Causes during the Past Sixty Years in Lingdingyang Estuary
	Kanglin Chen Sun Yat-sen University, China
11:50-12:05	The impact of physicochemical characteristics on the bacterial community composition and diversity in the Changjiang River plume area
	Qian Liu Second Institute of Oceanography, China
12:05-12:20	Organic carbon transfer across the open and closed estuary systems: a case study of Geum and Seomjin River systems, South Korea
	Sujin Kang Hanyang University, Korea

Wed.

Oral presentation



Marine Geology of Islands and Reefs

Conveners: Ying Wang, Chengdong Ge, Kefu Yu

Wed.

Oral presentation

10:50-11:05	River-Sea Interactive Processes Related to Marginal Seas Geomorphology: Examples from the Yellow Sea and East China Sea
	Ying Wang Nanjing University, China
11:05-11:20	New age evidences of evolution history for coral reef islands, northern South China Sea
	Tianlai Fan Guangxi University, China
11:20-11:35	The stratigraphy and sedimentary environment since the late Quaternary, South Yellow Sea coast to inner shelf and adjacent Yangtze delta regions, eastern China
	Yong Yin Nanjing University, China
11:35-11:50	Identification of diagenetic stage-diagenetic facies based on diagenesis process and reservoir porosity prediction: An example from Huagang Formation in Xihu Depression, East China Sea Basin
	Wendao Qian Yangtze University, China
11:50-12:05	Geothermal regime of the northern continental margin of the South China Sea
	Shaowen Liu Nanjing University, China
12:05-12:20	Session discussions



Sediment source-to-sink processes and environmental records in Asian continental margins

Conveners: Xuefa Shi, Steven Kuehl, Dhong-Il Lim, Shouye Yang, Sergey Gorbarenko

10:50-11:05	Sediment Routing from the Himalayan-Sourced Ganges-Brahmaputra Rivers to the Deep-Sea Bengal Fan from Detrital Zircons	Mike Blum	University of Kansas, USA
11:05-11:20	Evidence for Provenance Change in Deep Sea Sediments of the Bengal Fan: a 6 Ma record from IODP U1444A	Liping Zhou	Peking University, China
11:20-11:35	Allogenic controls on sediment transfer across the Ganges-Brahmaputra delta gateway	Steven Goodbred	Vanderbilt University, USA
11:35-11:50	Loess Plateau storage of Northeastern Tibetan Plateau derived Yellow River sediment	Junsheng Nie	Lanzhou University, China
11:50-12:05	Sedimentology, chronology, and provenance of the "Yangtze Gravel": Link the Lower Yangtze River to Late Cenozoic tectonic and climate in southeast China	Ping Wang	Nanjing Normal University, China
12:05-12:20	Glacial-interglacial sedimentation in the Bohai Sea, China during the last 1 Ma: evidence from magnetostratigraphic and astronomical tuning dating core	Zhengquan Yao	First Institute of Oceanography, China

Wed.

Oral presentation

Late Cenozoic ocean circulation, carbon cycle, and climate change in the western Pacific marginal seas

Conveners: Jun Tian, Jimin Yu, Zhonghui Liu

Wed. Oral presentation	10:50-11:05	Precession and glacial-cycle controls of monsoon precipitation isotope changes over East Asia during the Pleistocene	Enqing Huang	Tongji University, China
	11:05-11:20	Paleoceanography of the Japan Sea over the last 9.5 million years inferred from radiolarian assemblages (IODP Expedition 346 Sites U1425 and U1430)	Kenji Marc Raymond Matsuzaki	University of Tokyo, Japan
	11:20-11:35	Deep Water Circulation Changes in the Southern Ocean During the Transition of Late Pliocene - Early Pleistocene	Baoqi Huang	Peking University, China
	11:35-11:50	Pliocene carbonate burial in western equatorial Pacific	Hua Feng	Tongji University, China
	11:50-12:05	Neodymium isotopic evidence of abruptly intensified deep South China Sea overflow and gradually strengthened East Asian Monsoon in the Plio-Pleistocene	Jun Tian	Tongji University, China
	12:05-12:20	Possible tectonic controls on the development of the Middle-Late Miocene carbonate crash	Shijun Jiang	Jinan University, China



Quaternary shelf sand bodies in Asia and elsewhere: Processes and products

Co-chairs: Serge Berné, Daidu Fan

10:50-11:05	Study on sand wave fields in the Taiwan Banks	
	Ziyin Wu	Second Institute of Oceanography, China
11:05-11:20	Research on the Migration Rule of Sand Waves on the Outer Shelf of Northern South China Sea	
	Qikun Zhou	First Institute of Oceanography, China
11:20-11:35	Sedimentary features in the upper Jiulong submarine can-yon: a preliminary report of high-resolution ROV images	
	Daidu Fan	Tongji University, China
11:35-11:50	Review of researches on shelf tidal sands in China Seas	
	Ping Yin	Qingdao Institute of Marine Geology, China
11:50-12:20	Session discussions	

Wed.

Oral presentation



The 50 years of Ocean Drilling and Asian Marine Geology

Conveners: Yasuhiro Yamada, Gil Young Kim, Zhimin Jian

Wed.

Oral presentation

10:50-11:05	Expedition to the hidden continent (Zealandia): preliminary results based on lipid biomarker (IODP Exp. 371)
	Yu-Hyeon Park Pusan National University, Korea
11:05-11:20	Paleomagnetic and Rock Magnetic Studies of IODP Sites U1431 and U1433 in the South China Sea Basins
	Xixi Zhao Tongji University, China
11:20-11:35	Joint Development of the Next Generation Borehole Magnetometer by Korea-Japan and Its Prospect as a New Model of Collaboration in the International Ocean and Continental Drilling Programs
	Sang-Mook Lee Seoul National University, Korea
11:35-11:50	Mohole to Mantle (M2M) Drilling on the Horizon- Progress after 50 years
	Kyaw Moe R&D Center for Ocean Drilling Science, Japan
11:50-12:05	Activity and future plan of K-IODP
	Gil Young Kim Korea Institute of Geoscience and Mineral Resources
12:05-12:20	Near future directions in scientific drilling
	Yasuhiro Yamada ODS, JAMSTEC, Japan



Arctic gateway connecting the North Atlantic and North Pacific Oceans

Conveners: Rujian Wang, Leonid Polyak, Seung-II Nam, Masanobu Yamamoto

10:50-11:05	A thermohaline-driven intensification of the Atlantic Meridional Overturning Circulation during the abnormally long interglacial of marine isotope stage 11	
	Benoît Thibodeau	The University of Hong Kong, Hong Kong, China
11:05-11:20	Surface nutrient utilization in the Nordic Seas and its relevance for AMOC dynamics during MIS 11	
	John Doherty	The University of Hong Kong, Hong Kong, China
11:20-11:35	Deglacial and Holocene sea-ice variability north of Iceland and response to ocean circulation changes	
	Xiaotong Xiao	Ocean University of China
11:35-11:50	Holocene environmental changes in Woodfjorden of northern Spitsbergen, Svalbard archipelago	
	Young-Ji Joo	Korea Polar Research Institute, Korea
11:50-12:05	Authigenic and detrital neodymium isotopic compositions of surface sediments in Svalbard fjords: preliminary results	
	Kwangchul Jang	Korea Polar Research Institute, Korea
12:05-12:20	Impact of the Labrador Current flow speed to Atlantic meridional overturning circulation (AMOC) during the Holocene: sedimentological and organic geochemical perspectives	
	Harunur Rashid	Memorial University of Newfoundland, Canada

Wed.

Oral presentation



Seabed Mineral Resources: Recent Achievements and Challenges

Conveners: Sang-Joon Pak, Wonnyon Kim, Jonguk Kim

14:00-14:15	<p>Hydrocarbon preservation evaluation in the Laoshan Uplift of the South Yellow Sea Basin</p> <p>Penghui Zhang Hohai University, China</p>
14:15-14:30	<p>Discovery of active and inactive hydrothermal vents along the northern Central Indian Ridge</p> <p>Jonguk Kim Korea Institute of Ocean Science and Technology</p>
14:30-14:45	<p>Petrogenesis of subduction-related lavas from the southern Tonga arc</p> <p>Bora Myeong Korea Institute of Ocean Science and Technology</p>
14:45-15:00	<p>Geochemical constraints on the enriched mantle source beneath the North Fiji Basin</p> <p>Jihye Oh Korea Institute of Ocean Science and Technology</p>
15:00-15:15	<p>Tin Mineralization of Gold-Bearing Seafloor Hydrothermal Sulfides at Ocean Core Complex, 12.4°S, Central Indian Ridge</p> <p>Sun Ki Choi Korea Institute of Ocean Science and Technology</p>
15:15-15:30	<p>Geochemical and Microbial characteristics of ferro-manganese crusts on the seamounts in the northwestern Pacific</p> <p>Katsuhiko Suzuki Japan Agency for Marine-Earth Science and Technology</p>



Land-sea interaction processes and paleoenvironmental evolution in the joining area of Indian-Pacific Ocean

Conveners: CheAbd.Rahim Bin Mohamed, Shengfa Liu, Rina Zuraida, Narumol Kornkanitnan

14:00-14:15	Record of land-sea interaction through the Indian monsoon in the Mahanadi Basin (IODP Site U1445) of the Bay of Bengal during the last 200 ka
	Jongmin Lee Pusan National University, Korea
14:15-14:30	Sediment provenance based on detrital Sr-Nd isotopes in the Laxmi Basin (IODP Site U1456) of the Arabian Sea during the late Pleistocene
	Boo-Keun Khim Pusan National University, Korea
14:30-14:45	Chromium and gallium in suspended particles of Kelantan and Pahang Rivers: sources or sinks
	Che Abd Rahim Mohamed University Kebangsaan Malaysia
14:45-15:00	Land connections and disconnections of Sundaland (Last Glacial Maximum to Holocene) - Implications
	Edlic Sathiamurthy University Malaysia Terengganu, Malaysia
15:00-15:15	Peaty Sediment Distribution in the Straits of Malacca and its Potential use as the Sea Level indicators
	Abdullah Sulaiman Universiti Malaysia Terengganu, Malaysia
15:15-15:30	Calcareous Nannoplankton (marine algae) Analysis in Subsurface Sediments of Andaman Sea
	Rina Zuraida Marine Geological Institute of Indonesia



Sediment source-to-sink processes and environmental records in Asian continental margins

Conveners: Xuefa Shi, Steven Kuehl, Dhong-Il Lim, Shouye Yang, Sergey Gorbarenko

14:00-14:15	Seasonal variability in dust sources and transport processes over the Arabian Sea	
	Venkitasubramani Ramaswamy	CSIR-National Institute of Oceanography, India
14:15-14:30	Distribution characteristics, seasonal variability and dynamic mechanism of surface suspended sediment concentration in the Bohai Sea	
	Chongguang Pang	Institute of Oceanology, Chinese Academy of Sciences, China
14:30-14:45	Strontium isotopic compositions ($^{87}\text{Sr}/^{86}\text{Sr}$, $\delta^{88}\text{Sr}/^{86}\text{Sr}$) of dissolved and suspended loads from a mountain catchment during typhoon storms	
	Ni Su	Tongji University, China
14:45-15:00	Variations and controls of continental weathering and sediment transport in the Nile Basin since the Late Pleistocene	
	Nathalie Vigier	LOV, CNRS, Sorbonne University, France
15:00-15:15	Declined sediment source and connectivity: a basin-wide synthesis in the Changjiang River system	
	Leicheng Guo	East China Normal University, China
15:15-15:30	An integrated study on the fluvial sediment source-to-sink processes in the East Asian continental margin	
	Shouye Yang	Tongji University, China



Late Cenozoic ocean circulation, carbon cycle, and climate change in the western Pacific marginal seas

Conveners: Jun Tian, Jimin Yu, Zhonghui Liu

14:00-14:15	Variability of the Indonesian Throughflow thermal profile over the last 25-kyr: A perspective from the southern Makassar Strait
	Peng Zhang Northwest University, China
14:15-14:30	Southern Hemisphere forcing of onset of the MIS 14: evidence from Chinese loess and global records
	Qingzhen Hao Institute of Geology and Geophysics, China
14:30-14:45	Complexity of East Asian climate change since last glaciation
	Li Li Tongji University, China
14:45-15:00	Decoupled variability in surface and subsurface water temperature during late interglacial periods in the tropical southern South China Sea
	Liang Dong Tongji University, China
15:00-15:15	Depth distribution of organic carbon flux in the Japan Sea since 1.5 Ma
	Tomohisa Irino Hokkaido University, Japan
15:15-15:30	Climate dynamics of a 1400 Ma marine setting: An analogy to the Cretaceous Atlantic Ocean
	Xiaomei Wang China National Petroleum Corporation

Wed.

Oral presentation



Tropical processes in past global change: hydrology, weathering and carbon-cycle

Conveners: Yair Rosenthal, Enqing Huang, Haowen Dang

Wed.

Oral presentation

14:00–15:30

Open and free discussions

Past climate changes are tended to be viewed in the context of glacial cycles, while tropical climate changes are found to be able to respond directly to solar insolation forcing and exhibit strong variance at eccentricity and precession bands. This workshop aims to underlining the importance and the dependence of tropical process in the Earth's climate system. We plan to review and discuss recent progress in three major topics related to the tropical climate:

- (1) the hydrological cycle, e.g., monsoon and El Niño-Southern Oscillation;
- (2) weathering of tropical landmass and shelves;
- (3) perturbations of the carbon cycle via changes in alkalinity budget and tropical vegetation.

Invited talks related to these topics will be presented. Time is also reserved for an open discussion, especially how to foster and promote future studies in the framework of the International Ocean Discover Program (IODP).



Anthropocene Coasts under Global Changes

Conveners: Shu Gao, Ian Townend, Katsuto Uehara, HeeJun Lee

14:00-14:15	Wave-induced flows over crescentic bars in an open-coast beach, Korea	Hee Jun Lee	Korea Institute of Ocean Science and Technology
14:15-14:30	Sediment transport pattern in the southern Yellow Sea sand-ridges system	Yaping Wang	East China Normal University, China
14:30-14:45	Tidal Flat Dynamics Influenced by Along-coast Tidal Currents	Qian Yu	Nanjing Univseisity, China
14:45-15:00	Tidal Basin Infilling along the East China Sea Coast	Yunwei Wang	Hohai University, China
15:00-15:15	Dynamic equilibrium in the Qiantang Estuary, China	Dongfeng Xie	Zhejiang Institute of Hydraulics and Estuary, China
15:15-15:30	Sediment transport processes in a mountainous river subaqueous delta and its response to human activities	Aijun Wang	Third Institute of Oceanography, China

Wed.

Oral presentation

Arctic gateway connecting the North Atlantic and North Pacific Oceans

Conveners: Rujian Wang, Leonid Polyak, Seung-Il Nam, Masanobu Yamamoto

Wed.

Oral presentation

14:00-14:15	Dynamics of branches of the Bering Strait inflow in the Chukchi Sea during the Holocene
	Masanobu Yamamoto Hokkaido University, Japan
14:15-14:30	Micropaleontological and geochemical indicators of the Pacific waters in the Chukchi Sea: application for paleoceanological reconstructions
	Mariia Obrezkova POI FEB RAS, Russia
14:30-14:45	Microbial Biogeography from Seawater to Holocene Sediments in the Arctic Ocean
	Dukki Han Jeju National University, Korea
14:45-15:00	Reconstructing sea ice extent in the Chukchi Sea over the last 140 years: insights into the application of the PIP25 index
	Jung-Hyun Kim Korea Polar Research Institute
15:00-15:15	Diatom assemblage and nutrient regime changes in the southern subarctic Pacific Ocean since the late-Pliocene
	Ting Chen Southern University of Science and Technology, China
15:15-15:30	Paleoenvironmental changes recorded in the terrigenous sediments on Bering Sea northern slope since the last deglaciation
	Yechen Sun Tongji University, China



15:50-16:20	Scientific and engineering achievements of the D/V Chikyu - Core-Log-Seismic-Observatory Integration	
	Asahiko Taira	Japan Agency for Marine-Earth Science and Technology
16:20-16:50	The evolution of the Philippine Sea Plate and the origin of proto-arc basalt by seafloor spreading	
	Brian Taylor	University of Hawai'i at Manoa, USA

16:50-17:50



30th Anniversary of ICAMG

In 1988, the first ICAMG was held in Shanghai. During the ICAMG-9, a specific commemorative activity for 30th anniversary of ICAMG will be held. We warmly welcome all participants to join us and share your experiences with ICAMG during the last thirty years.

Wed.

Oral presentation



Venue 1

Advances in natural hydrate systems and methane seeps in marine settings

Conveners: Dong Feng, Min Luo, Xiqiu Han, Haibin Song

09:00-09:15	Occurrence of methane hydrate mounds inferred from geophysical survey in the eastern slope of the Chukchi Basin, Arctic Ocean	
	Young-Gyun Kim	Kangwon National University, Korean
09:15-09:30	Experimental Study on Correlation between Elastic Modulus of Gas Hydrate-Bearing Sediments and Gas Hydrate Saturation	
	Chul-Whan Kang	Korea Advanced Institute of Science and Technology
09:30-09:45	A recently active gas hydrate system with high concentration and geological controls in Shenhu area, South China Sea	
	Jiapeng Jin	Institute of Oceanology, Chinese Academy of Sciences, China
09:45-10:00	Geological and oceanographic controls on seabed fluid escape structures in a region of extensive seepage in the Northern Zhongjiannan Basin, South China Sea	
	Jiangxin Chen	Qingdao Institute of Marine Geology, China
10:00-10:30	Session discussions	



World's River Deltas: research progress and perspectives

Conveners: Yoshiki Saito, Steve Goodbred, Zhongyuan Chen

09:00-09:15	Recent Changes of the Asian Deltas: Rapid Shoreline and Seafloor Erosions
	Paul Liu North Carolina State University, USA
09:15-09:30	Coupled natural-system responses to anthropogenic change in the Ganges-Brahmaputra River delta Steven Goodbred Vanderbilt University, USA
09:30-09:45	Sedimentation and Coastal Area Management of Bangladesh Md Bazlar Rashid Bangladesh
09:45-10:00	The Fate of Ayeyarwady River Sediment: A Seismic Study Austin Chandler North Carolina State University, USA Pierce
10:00-10:15	Prehistoric shoreline changes of the Mekong delta, Vietnam Toru Tamura Geological Survey of Japan
10:15-10:30	Tide-dominated large-river deltas and estuaries: The Mekong River delta example Yoshiki Saito Shimane University, Japan

Thu.

Oral presentation

Paleoceanographic and climatic evolution and variability recorded in marginal and deep-sea western Pacific sediments; linking land-ocean in present and past

Conveners: Gert J de Lange, Michael Sarnthein, Zhimin Jian

Thu.
Oral presentation

09:00-09:15	The evolution of the Asian and American Monsoon recorded in ferromanganese crusts	Yang Wang	China University of Geosciences, China
09:15-09:30	Paleoclimatic and paleoceanographic records through Marine Isotope Stage 19 at the Chiba composite section, central Japan	Yusuke Suganuma	National Institute of Polar Research, Japan
09:30-09:45	Seawater-derived Nd isotopes in the western Pacific Ocean: implications for changes in weathering input over the last 30,000 years	Qiong Wu	Hohai University, China
09:45-10:00	The deep-water oxygenation changes in the South China Sea since the last glacial period	Gang Li	South China Sea Institute of Oceanology, China
10:00-10:15	Alkenone reconstructions of the subarctic Northwestern Pacific surface hydrography and sea surface temperature since the last glacial	Pai-Sen Yu	Taiwan Ocean Research Institute, Taiwan, China
10:15-10:30	Session discussions		



Interaction of tectonic-climate change with weathering and erosion processes in Asian continental margin

Conveners: Peter Clift, Christian France-Lanord, Shiming Wan

09:00-09:15	Clay mineral records in the Southern Bay of Bengal since 37 Ma: link to evolution of the Bay of Bengal and paleoenvironmental changes	Zehua Song	Institute of Oceanology, Chinese Academy of Sciences, China
09:15-09:30	Neogene erosion regime and climate of the Himalayan basin from the Bengal fan turbidite record	Christian France-Lanord	CRPG - CNRS, Universite de Lorraine, France
09:30-09:45	Tectonic and climatic controls on long-term silicate weathering in South China since 25 Ma	Shiming Wan	Institute of Oceanology, Chinese Academy of Sciences, China
09:45-10:00	Are lithium isotopes good proxies of continental silicate weathering?	Xiao-Ming Liu	University of North Carolina at Chapel Hill, USA
10:00-10:15	Reconstructing the East Asian Summer Monsoon intensification history in the Paleogene	Chang Liu	Louisiana State University, USA
10:15-10:30	The internal dynamics of sediment transport system controls on short-term silicate weathering in the Changjiang (Yangtze River) basin	Lei Bi	Tongji University, China

Thu.

Oral presentation

2nd China-Korea Joint Workshop on Gas Hydrate

Conveners: Nengyou Wu, Dae-Gee Huh

Thu. Oral presentation	09:00-09:15	Aerobic microbial oxidation of hydrocarbon gases (methane, ethane and propane): Experimental simulation	
		Jing Li	Qingdao Institute of Marine Geology, China
	09:15-09:30	Estimation of gas hydrate saturation from rock physics modeling and seismic inversion in the Ulleung Basin, East Sea	
		Bo-yeon Yi	Korea Institute of Geoscience and Mineral Resources
	09:30-09:45	Characteristics of natural gas hydrates in the Shenhu Sea Area of Northern South China Sea	
		Jiangong Wei	Guangzhou Marine Geological Survey, China
	09:45-10:00	Numerical simulations for accidental gas leakage and drill cuttings transport in water column associated with gas hydrate production in the Ulleung Basin, East Sea	
		Jong-Hwa Chun	Korea Institute of Geoscience and Mineral Resources
	10:00-10:15	Acoustic Characteristics and Micro-distribution Prediction during Hydrate Dissociation in Sediments from South China Sea	
		Gaowei Hu	Qingdao Institute of Marine Geology, China
	10:15-10:30	Resource assessment method of gas hydrate within seismic chimney structures in the Ulleung Basin	
		Nyeon-keon Kang	Korea Institute of Geoscience and Mineral Resources

Structure, magmatism and dynamics of marginal seas in Western Pacific

Conveners: Tianyao Hao, Sanzhong Li, Weiwei Ding, Zhen Sun

09:00-09:15	Characteristics of arc crust-mantle transition and mantle discontinuities beneath the western Pacific subduction zones
	Xiaobo He Zhejiang University, China
09:15-09:30	Subduction initiation: observations of how subduction begins
	Robert Hall Royal Holloway University of London, UK
09:30-09:45	Geodynamic effects of subducted seamount during single-sided continental overthrusting at the Manila Trench: Insights from numerical modelling
	Zihua Cheng Second Institute of Oceanography, China
09:45-10:00	Late Quaternary tectonic development, turbidite systems and volcanisms in the Southern Okinawa Trough
	Tien-Shun Andrew Lin National Central University, Taiwan, China
10:00-10:15	Regional three-dimensional lithospheric seismic velocity model of the South Yellow Sea and surroundings from joint inversion of gravity and surface-wave data
	Yanlin wen Shanghai Earthquake Administration, China
10:15-10:30	Session discussions

Thu.

Oral presentation

Nearshore Dynamic Processes and Hazards under Coastal Storms and Influence of Human Activities
Conveners: Bob Z You, Yongshen Wu, Qinghe Zhang, Jiawen Sun

09:00-09:15	Unified formula for erosion thresholds of sand, mud and sand-mud mixtures	
	Dake Chen	Hohai University, China
09:15-09:30	Shell debris in lagoon sediment core as a potential storm indicator: a case study of Li-An lagoon, Southeastern Hainan Island	
	Yanan Li	East China Normal University, China
09:30-09:45	Quantification of intertidal-dune morphodynamics and sediment transport based on unmanned aerial vehicle (UAV)-assisted photogrammetry	
	Dohyeong Kim	Seoul National University, Korea
09:45-10:00	Estimation of Wave Friction Factors on Movable Seabeds of Sediment	
	Zai-Jin You	Ludong University, China; University of Queensland, Australia
10:00-10:15	Influence of sediment sources on the special distribution of sandy-muddy transitional beaches in southeastern coastal China	
	Shaohua Zhao	Third Institute of Oceanography, China
10:15-10:30	Increasing threat of typhoons to coastal area in the western North Pacific between 1980 and 2015	
	Hongyuan Shi	Ludong University, China



Advances in natural hydrate systems and methane seeps in marine settings

Conveners: Dong Feng, Min Luo, Xiqiu Han, Haibin Song

10:50-11:05	Methane flux from "HaiMa" cold seeps at Qiongdongnan Basin , South China Sea
	Jiangong Wei Guangzhou Marine Geological Survey, China
11:05-11:20	Vivianite formation in methane-rich deep-sea sediments from the South China Sea
	Jiarui Liu China University of Geosciences, China
11:20-11:35	Authigenic minerals in sediments recovered during IODP 353 and its implication for the paleo-SMTZs
	Jiasheng Wang China University of Geosciences, China
11:35-12:20	Session discussions

Thu.

Oral presentation

World's River Deltas: research progress and perspectives

Conveners: Yoshiki Saito, Steve Goodbred, Zhongyuan Chen

Thu. Oral presentation	10:50-11:05	Mass Wasting Processes and Products of the Mississippi River Delta Front: Data Synthesis and New Insights	Samuel Bentley LSU College of Science, Baton Rouge, USA
	11:05-11:20	When will the sediment flux into the Changjiang River delta reach lowest?	Zhongyuan Chen East China Normal University, China
	11:20-11:35	Quantifying the impacts of human interventions on relative mean sea level change in the Pearl River Delta, China	Huayang Cai Sun Yat-sen University, China
	11:35-11:50	Impacts of Dam-orientated Water-Sediment Regulation Scheme on the Lower Reaches and Delta of the Yellow River, China	Houjie Wang Ocean University of China
	11:50-12:05	Holocene evolution of the Nakdong River delta, Busan, Korea	Eun Je Jeong Korea Institute of Ocean Science and Technology
	12:05-12:20	The response of Sr/Ba to salinity in artificial synthetic deltaic sediments	Aihua Wang Nanjing Center, China Geological Survey



Paleoceanographic and climatic evolution and variability recorded in marginal and deep-sea western Pacific sediments; linking land-ocean in present and past

Conveners: Gert J de Lange, Michael Sarnthein, Zhimin Jian

10:50-11:05	Deep hydrography of the South China Sea and deep water circulation in the Pacific since the last glacial maximum
	Sui Wan South China Sea Institute of Oceanology, Chinese Academy of Sciences, China
11:05-11:20	N.African paleo-river input to central-Mediterranean sediments during the Holocene – a high-resolution record
	Gert De Lange Utrecht University-Fac.Geosciences, Holland
11:20-11:35	The coldest climate on the appearance of the world's oldest stone arrowheads/pottery appeared in Japan
	Hodaka Kawahata University of Tokyo, Japan
11:35-11:50	Frequent and abrupt cold episodes around 4.2 ka in the Yangtze delta: the collapse of the earliest rice cultivating civilization
	Hiroto Kajita University of Tokyo, Japan
11:50-12:05	Discrepant in seawater isotope records deduced with hydrogen and oxygen isotopes in the northern South China Sea
	Juan He Tongji University, China
12:05-12:20	Session discussions

Thu.

Oral presentation

Interaction of tectonic-climate change with weathering and erosion processes in Asian continental margin

Conveners: Peter Clift, Christian France-Lanord, Shiming Wan

10:50-11:05	Increased seasonality and aridity drove the C4 plant expansion in Central Asia since the Miocene-Pliocene boundary	
	Xingyan Shen	Institute of Oceanology, Chinese Academy of Sciences, China
11:05-11:20	Interaction of climate change with weathering and erosion processes on eastern Luzon Island over various time scales	
	Zhaokai Xu	Institute of Oceanology, Chinese Academy of Sciences, China
11:20-11:35	Marine Records of Drainage Reorganization in Cenozoic Asia	
	Peter Clift	Louisiana State University, USA
11:35-11:50	History of Yellow and Yangtze River delivering sediment to the Yellow Sea since 3.5 Ma: tectonic or climate forcing?	
	Jin Zhang	Institute of Oceanology, Chinese Academy of Sciences, China
11:50-12:05	Orbital-scale evolution of Indian summer monsoon since 1.2 Ma: Evidence from clay mineral and geochemical records of the eastern Arabian Sea	
	Hongjin Chen	Institute of Oceanology, Chinese Academy of Sciences, China
12:05-12:20	Sea level-controlled sediment transport to the eastern Arabian Sea over the past 600 kyr: Clay minerals and Sr-Nd isotopic evidence from IODP Site U1457	
	Zhaojie Yu	Institute of Oceanology, Chinese Academy of Sciences, China

2nd China-Korea Joint Workshop on Gas Hydrate

Conveners: Nengyou Wu, Dae-Gee Huh

10:50-11:05	Sand production system for hydrate exploitation from clayey silt reservoirs	
	Yanlong Li	Qingdao Institute of Marine Geology, China
11:05-11:20	Well-bore stability study program in Korea for gas production from gas hydrate deposits in the Ulleung Basin, East Sea, Korea	
	Joo Yong Lee	Korea Institute of Geoscience and Mineral Resources
11:20-11:35	Evolving bearing capacity of an anchor plate during hydrate production: A THMC analysis	
	Fang Liu	Tongji University, China
11:35-11:50	Current laboratory studies on depressurization-induced gas hydrate production in KIGAM	
	Taewoong Ahn	Korea Institute of Geoscience and Mineral Resources
11:50-12:05	Effect of perforation on gas production from hydrate deposits in northern South China Sea	
	Yizhao Wan	Qingdao Institute of Marine Geology, China
12:05-12:20	Session discussions	

Thu.

Oral presentation

Structure, magmatism and dynamics of marginal seas in Western Pacific

Conveners: Tianyao Hao, Sanzhong Li, Weiwei Ding, Zhen Sun

10:50-11:05	Dynamic deformation and sedimentation in the North Luzon Trough forearc basin and evolution of a modern-forming melange onshore and offshore eastern Taiwan	
	Chi-Yue Huang	Tongji University, China
11:05-11:20	The lithosphere structure of North margin of South China Sea from gravity data	
	Ya Xu	Institute of geology and geophysics, China
11:20-11:35	The rift-to-drift transition in the South China Sea: Evidence from multi-channel seismic data and IODP Expeditions 367&368 drilling results	
	Weiwei Ding	Second Institute of Oceanography, China
11:35-11:50	The rifting-detachment-breakup process of the continental margin in the northern South China Sea and its relationship with magmatism	
	Zhen Sun	South China Sea Institute of Oceanology, , Chinese Academy of Sciences, China
11:50-12:05	Asymmetric Distribution of the Post-spreading Seamounts in the East Subbasin of the South China Sea	
	Yanghui Zhao	Second Institute of Oceanography, China
12:05-12:20	Exploring source regions of single- and double-frequency microseisms recorded in eastern North American margin (ENAM) by cross-correlation	
	Zhen Guo	Tongji University, China



Nearshore Dynamic Processes and Hazards under Coastal Storms and Influence of Human Activities

Conveners: Bob Z You, Yongshen Wu, Qinghe Zhang, Jiawen Sun

10:50-11:05	Wave Overtopping of Vertical Sea Dike on a Laboratory Fringing Reef
	Shaowu Li Tianjin University, China
11:05-11:20	Tidal propagation in the Fraser River Estuary
	Yongsheng Wu Bedford Institute of Oceanography, Canada
11:20-11:35	Effects of Ecological Restoration Project on Hydrodynamics at Shanhaiguan Tourism Beach
	Boling Dong Tongji University, China
11:35-11:50	Parameterization of Breaker Index for Random Wave Modelling
	Yuan Li Hohai University, China
11:50-12:05	Experimental study on formation and evolution of sandwaves under tidal currents and waves
	Zhipeng Zang Tianjin University, China
12:05-12:20	Modeling of Oil Spill in the English Bay
	Haibo Niu Dalhousie University, Canada

Thu.

Oral presentation

Plenary

129 Hall

Thu. Oral presentation	14:00-14:30	The Role of Marine Geology in Geoheritage Conservation
		Kyung Sik Woo Kangwon National University, Korea
	14:30-15:00	A Last Interglacial perspective on future rates of sea-level rise
		Eelco J. Rohling Australian National University, Australia
	15:00-17:50	Poster Sessions (Ground Floor, Zhonghe Building)



Exhibition Hall

Zhonghe Building
- Ground Floor

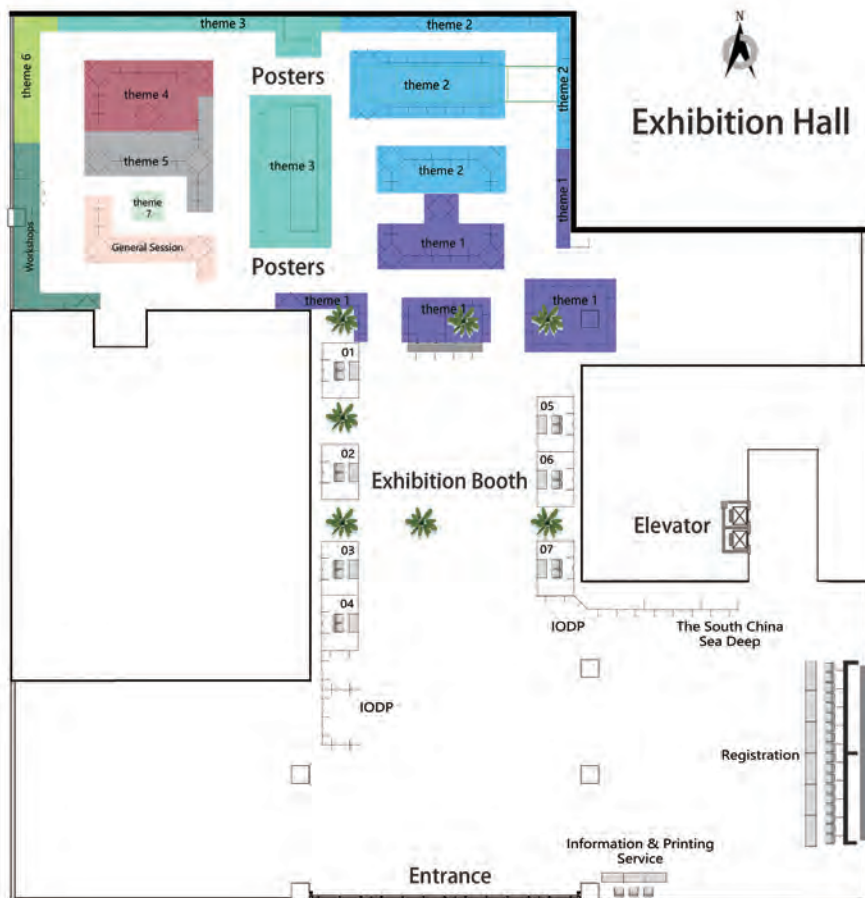

Marine Geohazards

Conveners: Yu Huang, Wuwei Mao

09:00-09:15	Gravity Current-Pipeline Interaction: Numerical Simulations	
	Eckart Meiburg	UC Santa Barbara, USA
09:15-09:30	Detection of submarine shallow gas and its risk assessment on marine engineering offshore of Zhoushan Islands	
	Ping Yin	Qingdao Institute of Marine Geology, China
09:30-09:45	Influence of Short Term rainfall on The Jamuna Marine Embankment Stability At bahuka, Shirajgonj, Bangladesh.	
	A.T.M. Hossain	Jahangirnagar University, Bangladesh
09:45-10:00	Geology and seismic profile around Krakatau waters	
	Soepri Wahyoe Hantoro	RCG IIS, Indonesia
10:00-10:15	Foraminifera Preservation Potential in the Paleotsunami : a Review	
	Eko Yulianto	Indonesian Institute of Sciences (LIPI), Indonesia
10:15-10:30	Session discussions	



Mechanisms of the South China Sea formation and ocean drilling

Conveners: Jian Lin, Zhimin Jian

09:00-10:30

Open and free discussions

Fri.

Oral presentation

Burial of organic carbon in the coastal margin under a changing world
Chair: Thomas Bianchi

09:00-09:15	Blue Carbon Sequestration Within a Northeastern Florida Intertidal Wetland - Response to Climate Change and Holocene Climate Variability
	Derrick Vaughn University of Florida, USA
09:15-09:30	Implications of eutrophication for biogeochemical processes in the Three Gorges Reservoir, China
	Xiangbin Ran First Institute of Oceanography, China
09:30-09:45	Biogeochemical characterization of Pearl River sediments using FTICR-MS and high throughput sequencing
	Wei Xie Sun Yat-sen University, China
09:45-10:00	Treated wastewater changes the export of dissolved inorganic carbon and its isotopic composition and leads to acidification in coastal oceans
	Xufeng Yang Ocean University of China, China
10:00-10:15	Black carbon (BC) geochemistry in East China Marginal Seas
	Yin Fang Tongji University, China
10:15-10:30	Session discussions

Fri.
Oral presentation



S15 Deep-Sea Sedimentary Processes: from Observations to Geological Records**W02 Particle Flux in the Oceans: Recent Progress and Future Perspectives**

Co-chairs: Martin Wiesner, Zhifei Liu

09:00-09:15	A comparison of monsoon derived biological pump in Asian Marginal Seas: South China Sea, Arabian Sea and Bay of Bengal
	Jianfang Chen Second Institute of Oceanography, China
09:15-09:30	Selective terrestrial organic matter loss in marine sediments
	Thomas Blattmann ETH Zurich, Switzerland
09:30-09:45	Modern transport process of terrigenous materials in the Gaoping Submarine Canyon off Taiwan
	Xiaodong Zhang Tongji University, China
09:45-10:00	Double-diffusive Sedimentation
	Eckart Meiburg UC Santa Barbara, USA
10:00-10:15	Calcification depths and temperature of planktonic foraminifera off southwest Hainan Island and their paleoceanographic implications
	Ismail Adejare Ladigbolu Second Institute of Oceanography, China
10:15-10:30	Current status of Coccolith downward fluxes and potential environmental drivers in northern SCS
	W.N.C. Priyadarshani Second Institute of Oceanography, China

Fri.

Oral presentation

Venue 5

GeoSummit Workshop on Coastal and Offshore Geology
Conveners: Se Won Chang, Ping Yin, Tomoyuki Sato, Huayan Gan

09:00-09:15	Origin and evolution of stacked cut-and-fill structures in the southwestern margin of the Ulleung Basin, East Sea (Japan Sea)
	Yong Joon Park Petroleum and Marine Research Division, Korea
09:15-09:30	Difference of subsurface structures of shelf due to tectonic setting around Japan
	Tomoyuki Sato Geological Survey of Japan
09:30-09:45	Coastal geo-hazards monitoring and mitigation practices in the Yangtze River Delta and adjacent offshore
	Ping Yin China Geological Survey, Qingdao, China
09:45-10:00	Sedimentary facies and depositional evolution of the Jeju Strait in response to late Pleistocene to Holocene sea level changes, southwest Korea
	Seok Hwi Hong Institute of Geoscience and Mineral Resources, Korea
10:00-10:30	Session discussions

Fri.
Oral presentation



S09 Sediment Gravity Flows: Processes, Products, and Implications to Resource Explorations

S14 When and how clastic detritus are transported from shelf-edge staging areas into deep-water areas: From a source-to-sink perspective

Co-chairs: Guangfa Zhong, Chenglin Gong

09:00-09:15	Inherent Biases in Sediment Routing to Deepwater: Concepts and Examples	Mike Blum	University of Kansas, USA
09:15-09:30	What are the required conditions for deltas at the shelf edge during rising sea level?	Jinyu Zhang	The University of Texas at Austin, USA
09:30-09:45	Sediment routing from onshore to abyssal plain: insight from detrital zircon analyses of the Gulf of Mexico Miocene deepwater fans	Jie Xu	China University of Geosciences, China; The University of Texas at Austin, USA
09:45-10:00	Grain size and transport regime at shelf edge as fundamental controls on delivery of shelf-edge sands to deepwater	Chenglin Gong	China University of Petroleum, China
10:00-10:15	Depositional facies of the Transgressive-Regressive Cycles of the Paleocene lower Wilcox, Gulf of Mexico based on a long continuous core	Shunli Li	China University of Geosciences, China
10:15-10:30	Basin margins clinoforms in outcrops; jurassic lajas and los molles formations, south neuquen basin, argentina.	Cornel Olariu	The University of Texas at Austin, USA

Fri.

Oral presentation

Nearshore Dynamic Processes and Hazards under Coastal Storms and Influence of Human Activities
Conveners: Bob Z You, Yongshen Wu, Qinghe Zhang, Jiawen Sun

09:00-09:15	Cohesive Sediment Transport and Fluid Mud Formation Simulation during Typhoon Processes: Linyungan Coast as An Example
	Qinghe Zhang Tianjin University, China
09:15-09:30	Coastal Modelling System for the Long-term Prediction of Morphology Change along the Coast of the East Asia
	Dong-Young Lee Ocean University of China
09:30-09:45	Linkage of wave models by NS equations solver and fully non-linear potential flow solver
	Hanbin Gu Zhejiang Ocean University, China
09:45-10:00	Study on wave-induced seabed response based on DEM-PFV coupling model
	Jinfeng Zhang Tianjin University, China
10:00-10:15	Study on numerical simulation of three-dimensional multi-directional freak waves based on OpenFOAM
	Cheng Cui Tianjin Research Institute of Water Transport Engineering, China
10:15-10:30	Trends of storm surge in the coastal areas of Zhejiang and Fujian Provinces
	Xingru Feng Institute of Oceanology, Chinese Academy of Sciences, China

Fri.
Oral presentation



Coastal dynamic and sea level change over time scales

Conveners: Yongqiang Zong, Fengling Yu

10:50-11:05	Sea-level behaviour during the Last Interglacial (MIS 5e) from far-field setting, Yorke Peninsula, Southern Australia
	Tsun-You Pan University of Wollongong, Australia
11:05-11:20	Change from tide-influenced deltas in a regression-dominated set of sequences to tide-dominated estuaries in a transgression-dominated sequence set, East China Sea Shelf Basin
	Shunli Li China University of Geosciences, China
11:20-11:35	Sea-level oscillations of the East China Sea and their implications for global seawater redistribution during 14.0-10.0 kyr
	Jiang Dong Institute of Oceanology, Chinese Academy of Sciences, China
11:35-11:50	Holocene sea-level history of the northern coast of South China Sea
	Yongqiang Zong University of Hong Kong, China
11:50-12:05	Holocene sea level change in the west coast of Bohai Bay
	Hong Wang Tianjin Centre, China Geological Survey, China
12:05-12:20	Palynological record of coastal wetland development in the Louisiana Chenier Plain since the mid-Holocene
	Qiang Yao Louisiana State University, USA

Fri.

Oral presentation

Burial of organic carbon in the coastal margin under a changing world

Chair: Peng Yao

10:50-11:05	Efficient burial of organic carbon in the hadal trenches
	Yunping Xu Shanghai Ocean University, China
11:05-11:20	Re-evaluating the use of BIT as a proxy for the relative abundance of terrestrial soil organic matter in sediments east off Taiwan
	Xiaoxia Lv China University of Geosciences, China
11:20-11:35	Sources and assimilation metabolism of archaea GDGTs in surface sediments of the Pearl River, China
	Xinxin Li Southern University of Science and Technology, China
11:35-11:50	Sedimentary organic matter compositions along the Pearl River in South China and their carbon cycle significance
	Baozhi Lin Tongji University, China
11:50-12:05	Centennial sedimentary responses of organic carbon burial to natural forcing and anthropogenic impacts along the East Asian continental margins
	Limin Hu First Institute of Oceanography, China
12:05-12:20	The Role of Reactive Iron in the Preservation of Terrestrial Organic Carbon in Estuarine Sediments
	Bin Zhao Ocean University of China

Fri.
Oral presentation



S15 Deep-Sea Sedimentary Processes: from Observations to Geological Records**W02 Particle Flux in the Oceans: Recent Progress and Future Perspectives**

Co-chairs: Gert J. de Lange, Jianfang Chen

10:50-11:05	Long-term in situ observations on typhoon-triggered turbidity currents in the deep sea
	Yanwei Zhang Tongji University, China
11:05-11:20	Transformation of hyperpycnal flows into turbidity currents
	Benjamin Kneller University of Aberdeen, UK
11:20-11:35	High-resolution Simulations of Gravity and Turbidity Currents
	Eckart Meiburg UC Santa Barbara, USA
11:35-11:50	In-situ observation of the subaqueous sand dunes at the upper slope of the northeast South China Sea
	Yulong Zhao Tongji University, China
11:50-12:05	Internal solitary waves and subaqueous sand dunes in the Dongsha region in the South China Sea
	Haibin Song Tongji University, China
12:05-12:20	Sedimentary dynamic processes of the Dongsha Contourite Drift formation in the South China Sea: Long-term in situ mooring observations
	Zhifei Liu Tongji University, China

Fri.

Oral presentation

Venue 5

GeoSummit Workshop on Coastal and Offshore Geology
Conveners: Se Won Chang, Ping Yin, Tomoyuki Sato, Huayan Gan

10:50-11:05	Sedimentary processes along the northeastern continental margin of the Korean Peninsula (East Sea): Climatic and tectonic controls	Deniz Cukur	Korea Institute of Geoscience and Mineral Resources
11:05-11:20	Architecture and Reservoir Quality of Low-Permeability Eocene Lacustrine Turbidite Sandstone From Dongying Depression, East China	Muhammad Jawad Munawar	University of the Punjab, Pakistan
11:20-11:35	Time gap in Holocene stratigraphy of Imja-do tidalflat, southwest coast of Korea	Hyun Ho Yoon	Korea Institute of Geoscience and Mineral Resources
11:35-11:50	Organic geochemical variation in Holocene sedimentary records and its implications for sediment dynamic processes in the Changjiang River mouth, China	Zhanghua Wang	East China Normal University, China
11:50-12:20	Session discussions		

Fri.

Oral presentation



S09 Sediment Gravity Flows: Processes, Products, and Implications to Resource Explorations**S14 When and how clastic detritus are transported from shelf-edge staging areas into deep-water areas: From a source-to-sink perspective**

Co-chairs: Changsong Lin, Ronald J. Steel, Chenglin Gong

10:50-11:05	Variations in submarine channel confluence and its implication for turbidity current activities	Yongpeng Qin	Institute of Deep-sea Science and Engineering, Chinese Academy of Sciences, China
11:05-11:20	Gravity flow deposits caused by different initiation processes in a deep-lake system	Tian Yang	China University of Petroleum
11:20-11:35	The characteristics and formation mechanism of carbonate and mixed filling deep-water canyon in Northwestern South China Sea	Yintao Lu	Petrochina Hangzhou Research Institute of Geology, China
11:35-11:50	Event sedimentation and sand body structure in deep water area of large depression basin	Qiang Fu	Tongji University, China
11:50-12:05	Recognition of ancient compound deltaic clinothem and how they are clothed by wave-, tide- and river-generated facies	Yang Peng	The University of Texas at Austin, USA
12:05-12:20	Quantifying sediment supply to deep-water basins: Application to the Paleogene Wilcox Group, Gulf of Mexico	Jinyu Zhang	The University of Texas at Austin, USA

Fri.

Oral presentation

General sessions

Conveners: Hao Cheng, Sugandha Panwar

10:50-11:05	Marine Geosciences Education and Research Initiative in Myanmar	
	Kyaw Moe	R&D Center for Ocean Drilling Science, Agency for Marine-Earth Science & Technology, Japan
11:05-11:20	Environmental magnetism to distinguish source lithology and sediment mixing pattern in the alakananda and ramganga sub-catchments, ganga basin, india	
	Sugandha Panwar	Tongji University, China
11:20-11:35	Tidal River Siltation and its Impact in the Coastal Parts of Bangladesh	
	Kamrul Ahsan	Geological Survey of Bangladesh, Bangladesh
11:35-11:50	Radiocarbon content of dissolved inorganic carbon from the Changjiang (Yangtze) estuary and the East China Sea	
	Shing-Lin Wang	National Taiwan University, Taiwan, China
11:50-12:05	Provenance, Tectonic Setting and Geochemical Maturity of the early Miocene Sediments, eastern part of Central Basin, Myanmar	
	Moe Soe Lwin	East Yangon University, Myanmar
12:05-12:20	Session discussions	



Coastal dynamic and sea level change over time scales

Conveners: Yongqiang Zong, Fengling Yu

14:00-14:15	Upper Tertiary to Recent geology of North Java offshore and coastal zone based on core and seismic data
	Soepri Wahyoe Hantoro RCG IIS, Indonesia
14:15-14:30	Geochemical studies on late Quaternary sediments of the Great Rann of Kachchh (GRK) basin, Western India
	Niteshkumar Khonde The Maharaja Sayajirao University of Baroda, India
14:30-14:45	Discrepancy between fine and coarse quartz OSL age dating results from continental shelf sediments in the Jeju Strait, Korea
	Jooah Choi Korea Institute of Geoscience and Mineral Resources
14:45-15:00	Human-induced changes in recent sedimentation rates in Bohai Bay, China: implications for coastal development
	Fu Wang Tianjin Center, China Geological Survey, China
15:00-15:15	Effect of channel morphodynamics on the intertidal-dune morphodynamics and associated sediment transport in the open-coast macrotidal flats, northern Gyeonggi Bay, west coast of Korea
	Joohee Jo Seoul National University, Korea
15:15-15:30	Session discussions

Low latitude Indo-Pacific marginal seas: variabilities in paleoclimatology and paleoceanography and their implications

Conveners: Sanmin Hyun, Rina Zurida

14:00-14:15	Importance of low-Latitude Indo-Pacific paleoceanographic and paleoclimatic study: review and an introduction to ongoing Indo-Pacific project by KIOST
	Sangmin Hyun Korea Institute of Ocean Science and Technology
14:15-14:30	Multi-decadal to centennial-scale variability in Australian-Indonesian monsoon intensity over the past two millennia
	Stephan Steinke Xiamen University, China
14:30-14:45	Multi-proxies evidence for abrupt climate change events at 8.2 ka simulations
	Eko Yulianto Institut Teknologi Bandung, Indonesia
14:45-15:00	Isotopic evidence for twentieth-century weakening of the Pacific Walker circulation
	Zhongfang Liu Tongji University, China
15:00-15:15	Environmental Changes off Aru Island, Molucca, Indonesia, during Holocene
	Rina Zuraida Marine Geological Institute of Indonesia
15:15-15:30	Stability of the glacial Kuroshio path with large meander in Shikoku Basin, NW Pacific
	Minoru Ikehara Kochi University, Japan



Seafloor sediment acoustics

Conveners: Baohua Liu, Gil Young Kim, Guangming Kan, Guanbao Li

14:00-14:15	Geoacoustic provinces of surface sediments in the southern part of the East Sea, Korea
	So-Ra Kim Korea Institute of Geoscience Mineral Resources
14:15-14:30	In situ and laboratory sound velocities of various seafloor sediments in the East Sea
	Kiju Park Korea Institute of Geoscience Mineral Resources
14:30-14:45	Geoacoustic provinces of velocity predicted by grain size of surficial sediments in the Northern South China Sea
	Yuhang Tian South China sea Institute of oceanology, Chinese Academy of Sciences, China
14:45-15:00	Laboratory Measurements of Sound Speed and Attenuation Dispersion in Calcareous Sediments from Coral Reefs
	Jingqiang Wang First Institute of Oceanography, China
15:00-15:15	Research on broadband high frequency sub-bottom profiler and experimental results
	Xinghui Cao Institute of Deep-sea Science and Engineering, Chinese Academy of Sciences, China
15:15-15:30	Session discussions

S15 Deep-Sea Sedimentary Processes: from Observations to Geological Records

W02 Particle Flux in the Oceans: Recent Progress and Future Perspectives

Co-chairs: Yanwei Zhang, Benjamin Kneller

14:00-14:15	The Source-to-Sink systems from Taiwan Island to the trenches of Manila and Ryukyu
	Kan-Hsi Hsiung R&D Center for Ocean Drilling Science, JAMSTEC, Japan
14:15-14:30	Recurrence of large tsunamis at the southern Ryukyu arc: A deep-sea turbidite evidence
	Ken Ikehara Geological Survey of Japan
14:30-14:45	Mixed sedimentary processes within the upper segment of Pearl River canyon, South China Sea
	Xingxing Wang Zhejiang University, China
14:45-15:00	Identification of sediment provenance in the Bellingshausen Sea and southern Drake Passage during glacial-interglacial period
	Young Kyu Park Yonsei University, Korea
15:00-15:15	Miocene-Pliocene deep-sea sedimentary environment evolution of the northern South China Sea: Record of high-resolution terrigenous grain size of ODP Site 1148
	Yijie Wang Tongji University, China
15:15-15:30	Thickness and Facies Trends along Depositional Dip in Turbidite Sand Sheets (Cerro Toro Formation, Magallanes Basin, Chile) — Any Implication for Allogenic Cycles?
	Jianan Wu University of Aberdeen, UK



Seafloor Failures: Triggering Mechanisms, Processes and Sedimentological Records

Conveners: Chih-Chieh Su, Jing-Yi Lin, Yi-Ching Yeh, Ho-Han Hsu

14:00-14:15	Submarine landslide: A case study from the southwestern of Taiwan offshore	
	Trong-Van Nguyen	National Central University, Taiwan, China
14:15-14:30	Styles of an isolated, latest Quaternary slope-failure system revealed from sedimentary features of downslope mass-transport deposits in the western margin of Ulleung Basin, East Sea (Japn Sea)	
	Sang Hoon Lee	Korea Institute of Ocean Science and Technology
14:30-14:45	Modern sedimentation and extreme event in the South China Sea	
	Yu-Huang Chen	National Taiwan University, Taiwan, China
14:45-15:00	Scissor-like spreading model and the jump of the oceanic ridge in the center basin of the South China Sea	
	Yan Qiu	Guangzhou Marine Geological Survey, China
15:00-15:15	Shear-wave velocity of marine sediments offshore Taiwan using ambient seismic noise	
	Jing-Yi Lin	National Central University, Taiwan, China
15:15-15:30	Seafloor instability in nearshore area of western Taiwan: evidence with High-Resolution Seafloor mapping	
	Chih-Chieh Su	National Taiwan University, Taiwan, China

Fri.

Oral presentation

Venue 6

S09 Sediment Gravity Flows: Processes, Products, and Implications to Resource Explorations

S14 When and how clastic detritus are transported from shelf-edge staging areas into deep-water areas: From a source-to-sink perspective

Co-chairs: Guangfa Zhong, Jingping Xu

14:00-14:15	Sedimentary budget of the Northwest Sub-basin, South China Sea: Controlling factors and geological implications
	Yanmei Wu Key Laboratory of Submarine Geoscience, China
14:15-14:30	Marine litter in a submarine canyon to the north of Xisha Trough, northern South China Sea
	Guangfa Zhong Tongji University, China
14:30-14:45	Drainage control of Eocene to Miocene sedimentary records in the southeastern margin of Eurasian Plate
	Yuchi Cui Tongji University, China
14:45-15:00	Comparison of incised valley estuary and tectonically-controlled estuary in the Brent Delta of the northern North Sea
	Xiaojie Wei Chinese Academy of Geological Sciences, China
15:00-15:15	Variations in slope channel architecture and fill from outcrop, Jurassic Neuquen Basin, Argentina
	Yuqian Gan University of Texas at Austin, USA
15:15-15:30	Session discussions



Preparing, Publishing and Reviewing a Scientific paper or Special Issue

Conveners: Gert J. de Lange, Shu Gao, Chun-Feng Li, Zhifei Liu

14:00-15:30

Open and free discussions

In this Workshop we aim to give a basic introduction into all aspects of writing, submitting, revising, evaluating, and publishing a scientific paper. In addition, we will explain common differences between types of research papers, and will outline what is needed to submit, manage, and produce a successful Special Issue. Although pertinent examples will be given as related to Marine Geology, the general outlines are applicable to most other scientific Journals.

We will start with a general introduction followed by more detailed outlines on relevant topics. Subsequently, we hope to move into a more interactive mode, where specific questions from participants will help to improve understanding of the functioning of creation and evaluation of scientific papers. Although the workshop is intended in particular for young scientists, certain aspects may also be relevant for more senior researchers.

Fri.

Oral presentation

Plenary

129 Hall

15:50-16:20	The Role of Aquatic Critical Zones in Coastal Carbon Cycling	
	Thomas S. Bianchi	University of Florida, U.S.A
16:20-16:50	Long-term in situ observations of deep-sea sedimentary dynamic processes	
	Zhifei Liu	Tongji University, China

16:50-17:20	Closing Ceremony and Awards	
-------------	-----------------------------	--

Fri.
Oral presentation



POSTER Session

Ground floor, Zhonghe Building



* indicates graduate student presenter
 legal candidate for the Best Student Poster

S01

ID	Title	Author	Affiliation
S01-P01-A0414	Source of the YZ02 hole in the South Yellow Sea shelf since the MIS6	Ling Zhang	Nanjing University, China
S01-P02-A1405	Mineral chemistry of clinopyroxene in basaltic pyroclastic rocks from kilometer-scale drilling in the northwestern South China Sea	Yu Zhang	Guangxi University, China
S01-P03-A1441	Diagenetic stages prediction based on diagenesis process: An example from the west of Bozhong sag	Wendao Qian	Yangtze University, China
S01-P04-A1459	Coral geochemical record of submarine groundwater discharge back to 1870 in the northern South China Sea	Wei Jiang	Guangxi University, China
S01-P05-A1953	Reconstruction of sea surface temperature in the northern South China Sea using Sr/Ca ratio of corals	Penglei Chai	Nanjing University, China
S01-P06-A2657	Multi-planning integration advancing coastal resources management: a case study from Hainan Island, China	Xin Zhao	Nanjing University, China

ID	Title	Author	Affiliation
S01-P07-A3010	Mineral composition and elemental geochemical characteristics of polymetallic nodules from the southwestern area off Dongsha Islands, northern continental margin of South China Sea	Xingjian Liu	South China Sea Institute of Oceanology, Chinese Academy of Sciences; Qingdao National Laboratory for Marine Science and Technology, China
S01-P08-A3650	Responses of δ 18O and δ 13C of well CK2 in Xisha, northern South China Sea to the evolution of East Asian monsoon during the past 1800 ka	Shendong Xu	Guangxi University, China
S01-P09-A3957*	A study on comparison and analysis of detailed bathymetry in the southern nearshores of the Dongdo and the Seodo of Dokdo, in the East Sea	Myoung Hoon Lee	Korea Institute of Ocean Science & Technology
S01-P10-A4246*	Grain-size characteristics of Lime-sand islands in the South China Sea and its significance for the development of Sand Island	Zhenqiang Ji	Nanjing University, China
S01-P11-A4563*	Environment and Resource Features of Weizhou Island and Analysis of Its Strategic Position	Minjing Wang	Nanjing University, China
S01-P12-A4797*	Species diversity and community characteristics of scleractinian coral in Nansha Islands, South China Sea	Liyao Yang	Nanjing University, China



POSTER Session

S03

ID	Title	Author	Affiliation
S03-P01-A0052	Distribution and Sources of Polycyclic Aromatic Hydrocarbons (PAHs) in Sediments of Indian Sundarban Mangrove in Gangetic Delta : An Approach to Remedial Measure	Santosh Sarkar	University of Calcutta, India
S03-P02-A0116	Attention to multi-component land subsidence of Me Kong delta, considering interaction of natural and antropogenic processes	Huy Giao Pham	Asian Institute of Technology, Thailand
S03-P03-A0915	Study on geomorphologic changes in the Pearl River Delta, 1850 – 2015	Ziyin Wu	Second Institute of Oceanography, China
S03-P04-A1019	Progress of a Marine Environmental Information System (MEIS) using Scientific data on Land – Sea Interaction in the Nakdong River Estuary, South Korea	Jun-Ho Lee	Korea Institute of Ocean Science & Technology
S03-P05-A1458*	Differentiating the effects of advection and resuspension on suspended sediment concentrations in a turbid estuary	Yuan Li	Nanjing University, China
S03-P06-A2455	The evolution process of Qingshuigou, an abandoned distributary channel of (Huanghe) Yellow River	Shuai Cong	Ocean University of China

POSTER Session

S04

ID	Title	Author	Affiliation
S04-P01-A3308	Holocene sea level change in the west coast of Bohai Bay	Hong Wang	Tianjin Centre, China Geological Survey, China

S05

S05-P01-A1616	A giant linear tidal sand ridge off the Garolim Bay mouth, macrotidal midwestern coast of Korea: morphologic response to human impacts and implications for the maintenance	Tae Soo Chang	Korea Maritime and Ocean University
S05-P02-A3463	Delta development during marine isotope stage 5 in the offshore area of Shandong Peninsula, western South Yellow Sea	Jiandong Qiu	Qingdao Institute of Marine Geology, China
S05-P03-A3787	Morphology and internal architecture of a banner bank of Chengshan Headland, Shandong Peninsula	Liangyong Zhou	Qingdao Institute of Marine Geology, China



ID	Title	Author	Affiliation
S06-P01-A0727	Influence of seepage flows on the erodibility of fluidized silty sediments: parameterization and mechanisms: parameterization and mechanisms	Yonggang Jia	Ocean University of China
S06-P02-A1228	Changes in the Coastal Depositional Condition by new Seawall Construction for Harbor Development in the West Coast of Korea	Tae-Jin Choi	Kunsan National University, Korea
S06-P03-A1242*	Modelling the Mophodynamics of a Beach at Qinhuangdao, China under storm waves using XBeach	Xuejian Han	Tongji University, China
S06-P04-A1515	Seasonal variations of sedimentary processes in the Nakdong River Estuary, Busan, South Korea	Han JunWoo	Korea Institute of Ocean Science & Technology
S06-P05-A1523	Investigation on Oscillatory Boundary Layer Flow over Rippled Bed through Three-Dimensional Lattice Boltzmann Simulation	Qinghe Zhang	Tianjin University, China
S06-P06-A1952*	Comprehensive analysis on the sediment movement process along the deep-water channel of the Yangtze estuary	Qixiong Liu	Zhejiang University, China
S06-P07-A2068*	Development of a three-dimensional hydrodynamic and sediment transport model for sandy beach evolution simulation	Chao Ji	Tianjin University, China
S06-P08-A2140	The flow in a Storm Surge Caused by Cold Air and its influence on channel siltation in Bohai bay	Bing Yan	Tianjin Research Institute of Water Transport Engineering, Ministry of Transport, China
S06-P09-A2184	Turbulence, sediment induced stratification, and mixing under macrotidal estuarine conditions (Qiantang Estuary, China)	Junbiao Tu	Tongji University, China

ID	Title	Author	Affiliation
S06-P10-A2348	Storm response of sand waves in the Taiwan Shoal	Jingjing Bao	Third Institute Of Oceanography, China
S06-P11-A2426	Study on Dynamical Forces of Flexible Turbidity Curtain Structure Using Physical Model and Numerical Model Tests	Shaowu Li	Tianjin University, China
S06-P12-A2430	Wave Overtopping of Vertical Sea Dike on a Laboratory Fringing Reef	Shaowu Li	Tianjin University, China
S06-P13-A2456	Study on the movement of fluid mud in the channel under the action of Typhoon	Zhang Na	Tianjin University, China
S06-P14-A3120*	Morphological response of channel-shoal system on an open coast to a major storm	Huidi Liang	Tongji University, China
S06-P15-A3194	Numerical study on wave damping performance of an arc-type plate breakwater	Xueyan Li	Yantai Institute of Coastal Zone Research, Chinese Academy of Sciences, China
S06-P16-A3214	Dynamic evolution and sustainable development strategy of sandy beach in Rizhao, Shandong, China	Nan Wang	Ocean University of China
S06-P17-A3258	Increasing threat of typhoons to coastal area in the western North Pacific between 1980 and 2015	Hongyuan Shi	Ludong University, China
S06-P18-A3431*	Role of waves and tides on high suspended sediment concentration in coastal waters of the Yellow Sea	Renfu Fan	Tianjin University, China
S06-P19-A3625*	Numerical Simulation of Storm-induced Coastal Dune Erosion	Hong Wang	Dalian University of Technology, China
S06-P20-A3678*	The distribution characters of surface sediments in tidal flat zone of Lingshan Bay, Qingdao	Lieyan Cao	China University of Petroleum, Beijing
S06-P21-A3844*	Wave skewness and asymmetry effects on sediment transport on a dissipative beach profile	Zhaoyan Xu	Ocean University of China



POSTER Session

S06

ID	Title	Author	Affiliation
S06-P22-A3947	Spatial and temporal sensitivities of key parameters in SWAN model: an example for CHAN-HOM typhoon waves in the East China Sea	Yao Xu	Nanjing University, China
S06-P23-A4076	Design of Gravel Beach Profile and Investigation of Its Stability via Physical Experiments	Jiawen Sun	National Marine Environmental Monitoring Center, China
S06-P24-A4080	Influences of seasonal wave variation on nearshore wave-induced currents and beach evolution	Jiawen Sun	National Marine Environmental Monitoring Center, China
S06-P25-A4499	Numerical simulation of solitary wave transformation over reef profile based on SPH	Jiawen Sun	National Marine Environmental Monitoring Center, China
S06-P26-A4785*	Field Investigation of Beach Stability on the Coast of Yantai	Bin Li	Ludong University, China
S06-P27-A4867*	In-situ Experimental Investigation of Geotextile Sand Bag Performance for Protection of Coastal Shoreline from Recession	Zaijin You	Ludong University, China
S06-P28-A4905	Coastal Inundation Assessment: Case Study for a Power Plant in South-Eastern Bangladesh	Xu Zhao	Tianjin Research Institute for Water Transport Engineering, Ministry of Transport, China
S06-P29-A4997*	Application of light backscattering method in observation of sediment concentration in surf and swash zone.	Bingchen Liang	Ocean University of China

ID	Title	Author	Affiliation
S08-P01-A0389*	Flow structure modification and drag reduction induced by sediment stratification in coastal tidal bottom boundary layers	Yun Peng	Nanjing University, China
S08-P02-A0512*	Seasonal Changes of Tidal Flat Profile in the Middle Jiangsu Coast, China	Yiyang Fan	Nanjing University, China
S08-P03-A1074*	Tide-induced residual bedload transport in two-dimensional tidal field	Zhiyun Du	Nanjing University, China
S08-P04-A2066	Variations in the transport, distribution and budget of 210Pb in sediment over the estuarine and inner shelf areas of the East China Sea due to Changjiang catchment changes	Jianhua Gao	Nanjing University, China
S08-P05-A2133*	Variation of net primary productivity in Arabian sea and Bay of Bengal using remote sensing data	Vinaya P	Mangalore University, India
S08-P06-A3579	Dynamic and geomorphic process in a transition zone of salt marsh and mudflat	Dezhi Chen	Nanjing University, China
S08-P07-A3860*	Formation and growth of a sand spit at Changhua River mouth, southern China	Yali Qi	Nanjing University, China
S08-P08-A4378	Tidal Flat Dynamics Influenced by Along-coast Tidal Currents	Qian Yu	Nanjing Univseisity, China



ID	Title	Author	Affiliation
S09-P01-A1374*	Sedimentary characteristics of submarine gravity flow in Baiyun Sag deep-water area, Pearl River Mouth Basin	Zhao Chen	China University of Geosciences, China
S09-P02-A2377	Characteristics of Gravity Flow in Chang 7 Oil Formation in Southeast Ordos Basin, China	Qiang Fu	Tongji University, China
S09-P03-A4086	Turbidite sequences recorded in sediment cores from the Manila Trench, South China Sea	Lisha Hu	Ocean University of China
S09-P04-A4329	High-concentration basal layers in oceanic turbidity currents	Zhiwen Wang	Ocean University of China
S09-P05-A4538*	Seismic characteristics of hydraulic jumps in the northern South China Sea basin	Biwen Wang	Tongji University, China

POSTER Session

S10

ID	Title	Author	Affiliation
S10-P01-A1186	A Field and Numerical Study on the Occurrence of Hyperpycnal Flow off the Mouths of Small Mountainous Rivers	Jia-Lin Chen	National ChengKung University, Taiwan, China
S10-P02-A1215*	Identification of diverse particle types in the water column on the Gaoping shelf, SW Taiwan	Peter Jue	National Sun Yat-sen University, Taiwan, China
S10-P03-A1443*	Response of the Changjiang River plume under a typhoon event	Zhiwei Zhang	East China Normal University, China
S10-P04-A2030*	Mild enrichment of redox-sensitive elements in core sediments off the Changjiang Estuary: controlling mechanisms and environmental implications	Yijing Wu	Tongji University, China
S10-P05-A2972*	Comparative Study on Cohesive Sediment Parameters Test and Computational methods in the Lingdingyang Estuary	Haoyan Dong	Sun Yat-Sen University, China
S10-P06-A2973*	Effects of the Flood Events on the sediment transport and waterway sedimentation in the Lingdingyang Estuary, Pearl River Delta, China	Zixiao He	Yen-sat University, Taiwan, China
S10-P07-A5363	New spatial-temporal distribution of superlobes in the Yellow River Delta Complex: a revised hypothesis	Lei He	Qingdao Institute of Marine Geology, China



POSTER Session

S11

ID	Title	Author	Affiliation
S11-P01-A1087	Lower silicate weathering degree of sediments in the northern Okinawa Trough during the Holocene than that in the late last glacial	Debo Zhao	Institute of Oceanology, Chinese Academy of Sciences, China

S12

S12-P01-A0317	Temporal and spatial characteristics of sediment sources on the southern Yangtze shoal over the Holocene	Chao Cao	Third Institute of Oceanography, China
S12-P02-A0395	Magnetic compositions of the East China Sea and its implications on provenance study	Yan Zheng	Institute of Vertebrate Paleontology and Paleoanthropology, Chinese Academy of Sciences, China
S12-P03-A0552	Holocene evolution of the shelf mud deposits in the north-western South China Sea	Gang Li	South China Sea Institute of Oceanology, Chinese Academy of Sciences, China
S12-P04-A0658*	Experimental investigation of sediment dynamics in response to shoaling high-frequency internal solitary wave packets over a steep slope	Xiujun Guo	Ocean University of China
S12-P05-A0687	Discrimination of sediment provenances in the central Bay of Bengal and climate control since 25 ka	Jingrui Li	First Institute of Oceanography, China

POSTER Session

S12

ID	Title	Author	Affiliation
S12-P06-A0743*	Testing contrasting models of formation of the Yellow River using heavy-mineral data from the Yinchuan Basin drill core	Haobo Zhang	Lanzhou University, China
S12-P07-A0882	Evolution and chronology of prograding lowstand wedges in the Korea strait	Dong-Geun Yoo	Korea Institute of Geoscience and Mineral Resources
S12-P08-A0888*	Seasonal variation of turbidity in Bohai sea	Xingmin Liu	Ocean University of China
S12-P09-A1022	Yangtze River-derived sediments in the southwestern South Yellow Sea: provenance discrimination and transport mechanism analysis	Jian Lu	Institute of Oceanology, Chinese Academy of Sciences, China
S12-P10-A1070	The detrital garnet chemistry of the Changjiang (Yangtze River) sediments and their provenance implication	Zhongbo Wang	Qingdao Institute of Marine Geology, China
S12-P11-A1199	Comminution age defined by $^{234}\text{U}/^{238}\text{U}$ disequilibrium and its application in constraining the time scale of sediment evolution in East Asia continental margin	Chao Ji	State Key Laboratory of Marine Geology, China
S12-P12-A1209*	Seismic stratigraphy and depositional history at the eastern Yellow Sea shelf since the Last Glacial Maximum	Bo Ram Lee	Korea Institute of Geoscience and Mineral Resources
S12-P13-A1382*	The evolution of hypoxia off the Changjiang estuary for the	Fahui Ren	Tongji University, China
S12-P14-A1534	High-resolution reconstruction of historical flood events in the Changjiang River estuary based on Sr-Nd isotopic signatures, Zr/Rb ratios and biomarkers	Rui Zhang	Institute of Oceanology, Chinese Academy of Sciences, China
S12-P15-A1645	Pyrite formation in mud sediments constrained by sedimentary environment on the East China Sea inner shelf	Xiting Liu	Ocean University of China



POSTER Session

S12

ID	Title	Author	Affiliation
S12-P16-A1901	Re-assessment of Contamination from Dispersed Elements in Sediments of Yangtze Estuary	Xiaoyu Zhang	Zhejiang University, China
S12-P17-A2227	Persisting impact of human activities to trace metals (Pb, Zn, Cu, Cr and As) in the sediment cores of Yangtze River estuary and adjacent areas during the last 60 years	Xueshi Sun	Ocean University of China
S12-P18-A2817*	Source and Sedimentary System of the First Member of Shahejie Formation in No.5 Tectonic Zone, Nanpu Sag, Bohai Bay Basin, Northeast China	Tianhao Gong	China University of Geosciences, China
S12-P19-A2943	Impact of the Three Gorge Dam construction on silicate weathering in the Changjiang Basin (China): evidence from major elements and Li isotopes	Chengfan Yang	Tongji University, China
S12-P20-A3153	The Ordovician-Silurian tectonic evolution of the northeastern margin of the Tarim block, NW China: Constraints from integrated depositional and geochronological records	Shunli Dong	Chengdu University of Technology, China
S12-P21-A3282	Application of the optically stimulated luminescence (OSL) technique in the Yangtze River delta of China	Xiaomei Nian	East China Normal University, China
S12-P22-A3310*	Clay mineral compositions in surface sediments of the Ganges-Brahmaputra-Meghna river system of the Bengal Basin, Bangladesh	Md Hafijur Rahaman Khan	South China Sea Institute of Oceanology, Chinese Academy of Sciences, China
S12-P23-A3407*	Response to changing in sediment load of the Yellow River of subaqueous clinoform off Shandong Peninsula, South Yellow Sea	Lijian Yang	Institute of Oceanology, Chinese Academy of Sciences; University of Chinese Academy of Sciences, China

POSTER Session

S12

ID	Title	Author	Affiliation
S12-P24-A3497*	Large fractionations of REE compositions observed in the Sediments from Small Rivers Draining Southeast China	Yulong Guo	Tongji University, China
S12-P25-A3637	Geochemistry of Holocene sediments from Beibu Gulf, South China Sea: Provenance and Paleoenvironment	Cui'ang Zhen	Guangzhou Marine Geology Survey, China
S12-P26-A3649	Sediment transport processes in the Pearl River Estuary as revealed by grain-size end-member modeling and sediment trend analysis	Tao Li	Guangzhou Marine Geology Survey, China
S12-P27-A3696	Detrital zircon U-Pb ages of surface sediment in the East China Sea: implications for provenance analysis and sediment budgeting	Xiangtong Huang	Tongji University, China
S12-P28-A3758*	Behavior of Li isotopes in the processes of continental weathering and riverine transport	Xiaodan Wang	Tongji University, China
S12-P29-A4192*	Characterization of turbidity channel in continental shelf basin and its source-to-sink influence: taking the first member of Huangliu Formation in Dongfang area of Yinggehai Basin as an example	Tanqiao Ping	Xi'an Shiyou University, China
S12-P30-A4233	Evolution of sedimentary environment and provenance since the late Pleistocene in the central Bohai Sea	Ying Wang	Nanjing University, China
S12-P31-A4496	Rare earth element characteristics of Pahang River and Kelantan River sediments and their tracing implication	Kaikai Wu	First Institution of Oceanography; National Oceanography Laboratory, China



POSTER Session

S12

ID	Title	Author	Affiliation
S12-P32-A4534*	Sediment source-to-sink of the northern Manila subduction zone near Taiwan	Kalyani Nayak	Department of Earth Sciences, China
S12-P33-A4737*	Early Miocene birth of modern Pearl River recorded low-relief, high-elevation surface formation of SE Tibetan Plateau	Licheng Cao	Tongji University, China
S12-P34-A4778	Provenance discrimination of the mud wedge on the East China Sea continental shelf: a review	Anchun Li	Institute of Oceanology, Chinese Academy of Sciences, China
S12-P35-A4901	Tectonic and Oceanographic Controls on Sediment Dispersal and Accumulation off the Ayeyarwady River Delta	Steven Kuehl	Xiamen University, China
S12-P36-A5138	Foraminiferal evolution and response to the channel diversion and discharge fluctuation of the Yellow River in the north Yellow Sea during the past century	Shiwen Zheng	Ocean University of China

ID	Title	Author	Affiliation
S14-P01-A0578*	Occurrence and seismic characteristics of stacked debris-flow deposits of the Ulleung Basin, East Sea	Yong Joon Park	Korea Institute of Geoscience and Mineral Resources
S14-P02-A2666	An integrated sequence stratigraphic analysis in three-dimensional perspective: A seismic case study of the Pearl River Mouth Basin, northern South China Sea	Shaohua Xu	Chongqing University of Science and Technology, China
S14-P03-A3495*	Application of 3D visualization technology in the Orient waterway system in Yinggehai Basin	Tanqiao Ping	Xi'an Shiyou University, China
S14-P04-A3514*	Discussion on sediment source and main controlling factors of the Quaternary in Dongfang area, Yinggehai Basin	Peng Zhang	Xi'an Shiyou University, China
S14-P05-A3891*	Genesis and evolution of the mass-transport deposits in the middle segment of the Pearl River canyon, South China Sea	Xingxing Wang	Zhejiang University, China
S14-P06-A4213	Growth-fault Controlled Outer Shelf Conduits near the Pliocene Orinoco Shelf-edge	Si Chen	China University of Geosciences, China



POSTER Session

S15

ID	Title	Author	Affiliation
S15-P01-A0668	Settling of Cohesive Sediment: Particle-resolved Simulations	Eckart Meiburg	UC Santa Barbara, USA
S15-P02-A2356*	An overview of the sedimentary process of the Bengal Fan	Chun Yan	Hangzhou Institute of Petroleum Geology, China
S15-P03-A2433	Deposition dynamics of alkenone in the deep sea and the construction of time series on alkenone proxy of sea surface temperatures since the Last Glacial Maximum in the northern abyssal plain of the South China Sea	Jiangyong Zhang	Guangzhou Marine Geological Survey, Ministry of Natural Resources, China
S15-P04-A2968	Seasonal variations of radiolarian shells in the deep water from the northern South China Sea	Lanlan Zhang	South China Sea Institute of Oceanology, Chinese Academy of Sciences, China
S15-P05-A5208	Antarctic Circumpolar Circulation variability and frontal migration during the past glacial-interglacial cycles	Xufeng Zheng	South China Sea Institute of Oceanology, Chinese Academy of Sciences, China

POSTER Session

S16

ID	Title	Author	Affiliation
S16-P01-A1108	Precession- and glacial-cycles regulate the Fe-rich sediment supplies from Papua New Guinea to the Equatorial Pacific	Haowen Dang	Tongji University, China
S16-P02-A4085	Reconstructing the thermal structure of the upper ocean in the western Philippine Sea over the last four glacial cycles	Qi Jia	First Institute of Oceanography, China
S16-P03-A4164	Heat transport processes of the Indonesian throughflow in the Western Pacific since the last interglacial	Xuan Ding	China University of Geosciences, China

S17

S17-P01-A1014*	The Sunda Shelf – a carbon sink during the last glacial period?	Jinlan Li	Tongji University, China
S17-P02-A1243*	The Holocene vegetation composition reconstruction supports the inference that shifts in Chinese stalagmite $\delta^{18}\text{O}$ represent changes in regional monsoon rainfall	Fenghao Liu	Tongji University, China
S17-P03-A1716*	A 16 Myr record of GDGTs and alkenone biomarkers from IODP Site U1337.	Jingjing Liu	Tongji University, China
S17-P04-A2671*	The relationship between late Miocene ocean carbon shift and productivity related to coccolithophore in the Western Equator Pacific	Fangzhou Li	Tongji University, China
S17-P05-A3131*	Modeling the Late Miocene Carbon Shift using a box-model: Ocean carbon reservoir under terrigenous flux forcing	Jinlong Du	Tongji University, China



POSTER Session

S17

ID	Title	Author	Affiliation
S17-P06-A3631	Intensified aridity in the Qaidam Basin during the middle Miocene: constraints from ostracod, stable isotope and weathering records	Bowen Song	China University of Geosciences, China
S17-P07-A3663	Coral reef record of climate and environment changes in the northern South China Sea since Pliocene	Wei Jiang	Guangxi University, China
S17-P08-A3818	Morphological diversity of Quercus fossil pollen in the northern South China Sea during the last glacial maximum and its paleoclimatic implication	Lu Dai	Ningbo University, China
S17-P09-A3822*	Cd/Ca record from U1337 benthic foraminifera questions the hypothesis that the strengthening of NADW leads to the Late Miocene Carbon Isotope Shift	Yu Feng	Australian National University, Australia
S17-P10-A3973	Abruptly intensified vertical mixing in the deep South China Sea during the late Miocene: Evidence from non-conservative fish teeth Neodymium isotope record	Ke Li	Tongji University; Second Institute of Oceanography, China
S17-P11-A4044	Monsoon precipitation and temperature controls on the abundance of C4 plants in subtropical East Asia during the Pleistocene	Yunru Chen	Shanghai Jiao Tong University, China
S17-P12-A4686	Ocean redox during the Cryogenian interglaciation	Yuntao Ye	China National Petroleum Corporation

POSTER Session

S18

ID	Title	Author	Affiliation
S18-P01-A2779	Mass inventory of polychlorinated biphenyls in sediments of the Yangtze River estuarine-inner shelf, the East China Sea	Zhigang Guo	Fudan University, China
S18-P02-A3146	Silica characteristics of the Longmaxi Formation black shale at the southwestern Yangtze Platform and its geological significance	Shaoze Zhao	Chengdu University of Technology, China
S18-P03-A3962	Distribution and source of sedimentary organic matter in the Yellow Sea	Daun Kim	Hanyang University, Korea
S18-P04-A3963*	Paleoenvironment reconstruction using multi proxies of terrestrial organic matter records for past 25,000 years in the Ryukyu trench	Gurpreet Kaur	Soka University Japan, Japan
S18-P05-A4245	Molecular distribution and composition of sedimentary organic matter from the Gulf of Thailand: assessment of OM sources and environmental implications	Yazhi Bai	First Institute of Oceanography, China



POSTER Session

S19

ID	Title	Author	Affiliation
S19-P01-A1301	Enhanced North Pacific ventilation during the Miocene/Pliocene boundary	Lina Zhai	Institute of Oceanology, Chinese Academy of Sciences, China
S19-P02-A1626*	Anthropogenic alternation of natural vegetation process began thousands of years ago in southern China	Zhongjing Cheng	Tongji university, China
S19-P03-A2319	Paleoceanography of turbiditic sediments in the central South China Sea: IODP 349 records	Qianyu Li	Tongji University, China
S19-P04-A2335	Grain Size Inter-comparison Project on South China Sea Sediments – An Introduction	Jie Huang	Institute of Oceanology, Chinese Academy of Sciences, China
S19-P05-A2558	Eocene-Oligocene Calcareous Nannofossil Biostratigraphy and Paleoceanographic study in the northern South China Sea	Ruigang Ma	Tongji university, China
S19-P06-A2577*	Obliquity-paced thermocline water temperature change in the western equatorial Pacific across the mid-Pleistocene transition	Xingxing Wang	Tongji University, China
S19-P07-A2660*	A 450-kyr planktonic foraminiferal assemblage record of IODP site U1352 and its implications for the migration of the subtropical front in the southwest Pacific	Yingying Wu	China University of Geosciences, China
S19-P08-A2871*	Miocene paleoenvironmental evolution based on benthic foraminiferal assemblages in the Lufeng Sag, northern South China Sea	Liyuan Xue	China University of Geosciences, China
S19-P09-A3909	Fire history in the Yangtze River basin since 7 ka and implications for linkages to climate, vegetation and human activities	Wenqiang Pei	Institute of Oceanology, Chinese Academy of Sciences, China
S19-P10-A4287	The deep-water oxygenation changes in the South China Sea since the last glacial period	Gang Li	South China Sea Institute of Oceanology, Chinese Academy of Sciences, China

POSTER Session

S19

ID	Title	Author	Affiliation
S19-P11-A4288	Coccolith isotopic vital effects driven by coccolithophore cell size and productivity over the 400 ka	Chuanlian Liu	Tongji University, China
S19-P12-A4383	Deep water carbonate ion concentrations in the South China Sea during the last glacial-interglacial cycle: Implications for the effect of ocean alkalinity and carbon transfer	Kanglin Chen	Sun Yat-sen University, China
S19-P13-A4680	Evolution of the Southern Yellow Sea Cold Water Mass During the Last 7 ka: Benthic Foraminiferal Evidence	Rong Xiang	South China Sea Institute of Oceanology, Chinese Academy of Sciences, China
S19-P14-A4774*	Sea level and climatic controls on turbidite occurrence for the past 26 kyr on the flank of the Gaoping Canyon off SW Taiwan	Shun-Wen Yu	National Central University, Taiwan, China



POSTER Session

S21

ID	Title	Author	Affiliation
S21-P01-A1825*	A 350-kyr planktonic and benthic foraminiferal assemblage record of IODP site U1446 and its implications on Indian Monsoon evolution	Duo Wang	China University of Geosciences, China
S21-P02-A2257	REE geochemistry and paleoenvironmental characteristics in the Ulleung Basin, East Sea (Sea of Japan), over the past 120 kyr BP	Jeongwon Kang	Korea Institute of Ocean Science and Technology
S21-P03-A2266	Carbon isotope and n-alkanes records from the nearby Mahakam delta and Arafura Sea, Indonesia: implications of Holocene paleoenvironmental changes	Sangmin Hyun	Korea Institute of Ocean Science and Technology
S21-P04-A4311*	Middle to Late Pliocene Molluscan Assemblages from Ilocos Sur, northern Philippines and their Paleoenvironmental Implications	David Policarpio	National Institute of Geological Sciences, Quezon City, Philippines
S21-P05-A4938	Investigating The Precession Responses Of Tropical Indo-pacific Hydroclimate Since The Last Glacial	Ziye Li	Ocean University of China
S21-P06-A5099	Holocene condition off aru and surrounding, molucca, indonesia, revealed from microfaunal assemblages	Luli Gustiantini	Marine Geological Institute of Indonesia
S21-P07-A5286*	Foraminifera as an Effective and Affordable Proxy to Reveal Paleoclimate and Paleoceanography on Indo-Pacific Tropical Region	Ryan Dwi Wahyu Ardi	Institut Teknologi Bandung, Indonesia

ID	Title	Author	Affiliation
S23-P01-A0185*	P-wave velocity structure of crust beneath the junction area between North China block and Yangtze block	Weina Zhao	Guangdong Ocean University, China
S23-P02-A0247*	Late Oligocene tectonic inversion in the Liaodong Bay Subbasin, Bohai Bay Basin, China and its tectonic significance—insights from thin shell FE modelling	Panpan Hu	Tongji University, China
S23-P03-A0686*	Stratigraphy of the backarc basin fills that record early tectonic inversion: an example from the Miocene of Eastern Shimane in Southwest Japan	Hikari Matsuzawa	Shimane University, Japan
S23-P04-A0870	Magma-magma interaction in the mantle recorded by megacrysts from Cenozoic basalts in eastern China	Xun Yu	Tongji University, China
S23-P05-A1754*	Tectonic evolution and fault system characteristics of Wanan Basin, South China Sea	Yang Wan	China University of Geosciences, China
S23-P06-A3419	Late Cenozoic subsidence and sedimentary features of the basins in the northwestern South China Sea: implications for the development of the deep anomalous progress	Mei Chen	Guangzhou Marine Geological Survey, China
S23-P07-A4243*	The anisotropic structure of the South China Sea by forward modeling of PKS phase	Ting Wang	Tongji University, China
S23-P08-A4252*	Seismic Anisotropy in Izu-Bonin Subduction Zone using data from the Seafloor Observation Network DONET	Yuan Liu	Tongji University, China
S23-P09-A4294*	Sedimentary and tectonic features of the Caroline Ridge and its implication for rifting model, from the latest geophysical survey	Zhengyi Zhang	Chinese Academy of Sciences, China



POSTER Session

S23

ID	Title	Author	Affiliation
S23-P10-A4652	Tectono-stratigraphic framework of the hyper-extended Liwan sag: an insight into the transition from active margin to passive margin	Cuimei Zhang	South China Sea Institute of Oceanology Chinese Academy of Sciences, China
S23-P11-A4667*	Comparison of structural differences and stretch patterns in the continental margin of the south China sea	Wenlong Wang	Institute of oceanology, Chinese Academy of Sciences, China

S24

S24-P01-A0478	Implementation of Machine Learning and data mining in Geo-acoustic study	Zhengyu Hou	South China Sea Institute of Oceanology Chinese Academy of Sciences, China
S24-P02-A0513*	Acoustic backscattering measurement at 6 – 24 kHz from sandy seafloor in the Yellow Sea	Guangming Kan	First Institute of Oceanography, China
S24-P03-A0527	Relationship between porosity and sound speed of seafloor surface sediments	Dapeng Zou	Guangdong University of Technology, China
S24-P04-A0532	Primary study on characteristics of shear wave dispersion in Porites	Zhengyu Hou	South China Sea Institute of Oceanology Chinese Academy of Sciences, China
S24-P05-A0937*	A study on the distribution of surface sediments in the southern Korean Peninsula using data of Acoustic Sound Measurement System	Shin Yu	Korea Institute of Geoscience and Mineral Resources
S24-P06-A2748	The geoacoustic characteristics of transition layer in the Beibu Gulf, northern South China Sea	Cheng Tang	Yantai Institute of Coastal Zone Research, Chinese Academy of Sciences, China
S24-P07-A3756	In situ and laboratory acoustic attenuation measured in the sediments of the southern Yellow Sea	Xiangmei Meng	First Institute of Oceanography, China

POSTER Session

S25

ID	Title	Author	Affiliation
S25-P01-A0177	The evolution of gravity-driven system coupling with diapirism in Zengmu Basin, southern South China Sea: under the control of prograded shelf-margin delta system	Junjie Xu	China University of Geosciences, China
S25-P02-A0677	Fangliao Slide — a large slope failure in the upper Kaoping Slope off southwest Taiwan	Song-Chuen Chen	Central Geological Survey, Ministry of Economic Affairs, Taiwan, China
S25-P03-A0780	Geophysical Investigation of Shallow Subsurface Stress State on the Accretionary Prism off Southwest Taiwan	Win-Bin Cheng	Jinwen University of Science and Technology, Taiwan, China
S25-P04-A2358	Causal Factors of Seafloor Instability in Taiwan Strait - Sedimentary and Structural Characteristics of the Western Taiwan Foreland Basin	Ho-Han Hsu	National Taiwan University, Taiwan, China

S26

S26-P01-A0623	Assessment on the potential tsunami intensity along the East China Coast in worst case of earthquake occurred in Nankai Trough, Japan	Yanlin Wen	Shanghai Earthquake Administration, China
S26-P02-A4593*	Characterizing the offshore segment of the wrench fault system in the eastern border of the Zambales Mountains, Northwest Luzon, Philippines	Paul Caesar Flores	University of the Philippines



POSTER Session

S26

ID	Title	Author	Affiliation
S26-P03-A4596*	Geophysical mapping of submarine groundwater discharge (SGD) in Mabini, Batangas, South Luzon, Philippines	Paguergan Mary Rose Gabuyo	University of the Philippines

S27

S27-P01-A0635	The stable isotope fingerprint of chemosymbiosis in the shell organic matrix of seep-dwelling bivalves	Dong Feng	South China Sea Institute of Oceanology, Chinese Academy of Sciences, China
S27-P02-A1521	The effect of diagenesis and fluid migration on rare earth element and organic matter distribution in sediments of South China Sea	Niu Li	South China Sea Institute of Oceanology, Chinese Academy of Sciences, China
S27-P03-A1526	Porewater geochemistry of shallow sediments in the Beikang Basin of the southern South China Sea: implication for methane seepage	Junxi Feng	Guangzhou Marine Geological Survey, China
S27-P04-A1617	An areal quantitative study of subseafloor carbon cycling in cold seeps and hydrate-occurring areas in the northern South China Sea	Yanping Zhang	Shanghai Ocean University, China
S27-P05-A2345*	A comparative study of authigenic carbonates from oil and methane seep environments	Yuedong Sun	South China Sea Institute of Oceanology, Chinese Academy of Sciences, China

POSTER Session

S27

ID	Title	Author	Affiliation
S27-P06-A2759*	Distribution and Genesis Mechanism of Submarine Landslides in the Northeastern South China Sea	Kun Zhang	Tongji University, China
S27-P07-A2760	Dissolved methane distributions and air-sea flux from hydrocarbon seeps in the Lintou Promontory seep field, Northern South Sea	Pengfei Di	South China Sea Institute of Oceanology, Chinese Academy of Sciences, China
S27-P08-A2778	The thermodynamic characteristics of mud diapir fluid and its influence on hydrate accumulation	Zhifeng Wan	Sun Yat-sen University, China
S27-P09-A3039*	Triple sulfur isotope relationships during sulfate driven anaerobic oxidation of methane	Shanggui Gong	Louisiana State University, USA.
S27-P10-A3379*	Types and characteristics of the morphological parameters of the columnar seismic anomalies, implications for the columnar fluid flow structures and fluid activities	Boda Zhang	Sun Yat-sen University, China
S27-P11-A3711	Gas hydrate migration and accumulation system (GHMAS): Key factors controlling the formation and distribution for marine gas hydrate	Ming Su	Sun Yat-sen University, China
S27-P12-A3949	Microbial Diversity of two cold seep systems in gas hydrate-bearing sediments at Site GMGS2-08 in the South China Sea	Hongpeng Cui	China University of Geosciences, China
S27-P13-A3975*	Precipitation of low-magnesium calcite in today "s" Aragonite Sea' at SS296 and GC53 of the Gulf of Mexico	Huiwen Huang	South China Sea Institute of Oceanology, Chinese Academy of Sciences, China
S27-P14-A4124	Study on Authigenic Minerals Formation in Marine Cold Seep: Insight from the Laboratory Test	Congming Wei	Key Laboratory Submarine Geosciences & Second Institute of Oceanography, China



POSTER Session

S27

ID	Title	Author	Affiliation
S27-P15-A4244	Iron shuttle controls Mo-As-Sb enrichment in Pliocene cold-seep carbonates from the southern Western Foothills, Southwestern Taiwan	Qinxian Wang	Shanghai Ocean University, China
S27-P16-A4413	Foraminifera from gas hydrate-bearing sediments of the northeastern South China Sea: proxy evaluation and application for methane release activity	Sui Wan	Guangzhou Institute of Geochemistry, Chinese Academy of Sciences, China
S27-P17-A4539	Seepage environments recorded by dolomite from the Gulf of Mexico	Hongpeng Tong	Shanghai Ocean University, China
S27-P18-A4900	Numerical simulation of gas composition differentiation during gas hydrate accumulation	Yuncheng Cao	Shanghai Ocean University, China

POSTER Session

S28

ID	Title	Author	Affiliation
S28-P01-A0470*	Nano-scale study of iron oxide/oxyhydroxide in hydrothermal vent microbial mat	Hanbeom Park	Yonsei University, Korea
S28-P02-A1550	The progress in China of the REE geochemical study for REE-bearing sediments in the Pacific Ocean	Chengzhu Jiang	Development and Research Center of China Geological Survey, China
S28-P03-A3664	A study on depositional characteristics of the Jurassic and sedimentary model in Chaoshan Sub-basin, northern South China Sea	Kunsheng Qiang	Guangzhou Marine Geological Survey, China
S28-P04-A3768*	Shipboard magnetic and rock-magnetic characterization of hydrothermal activities in the North Fiji basin	Gyuha Hwang	Korea Institute of Ocean Science & Technology
S28-P05-A4592	The axial valley morphology and related hydrothermal activities at the Central Spreading Ridge, the North Fiji basin	Sang-Joon Pak	Korea Institute of Ocean Science & Technology

S29

S29-P01-A0603	Rare earth elements in the sediments from the Chukchi and East Siberian seas	Valentina Sattarova	V.I.Il'ichev Pacific Oceanological Institute (POI), Russia
S29-P02-A1230*	Neoglobobadrina pachyderma in the modern Arctic Ocean: a potential for its morphological variation for paleoceanographic reconstruction	Yeong-Ju Son	Korea Polar Research Institute
S29-P03-A1320	Towards an improved sediment stratigraphy and Better understanding of the Pleistocene glacial history in the western Arctic Ocean	Seung-Il Nam	Korea Polar Research Institute



POSTER Session

S29

ID	Title	Author	Affiliation
S29-P04-A1764	History of the Atlantic Layer on Chukchi Plateau during the last glacial-interglacial cycle based on ostracodes	Baochun Zhou	Shanghai Natural History Museum, China
S29-P05-A2500	Enhanced ventilation in the abyssal Southern Ocean at recent five glacial terminations	Li Wu	Tongji University, China
S29-P06-A2532*	Foraminiferal assemblages in the Western Arctic surface sediments and their paleoenvironment implications	Defang You	Tongji University, China
S29-P07-A2691*	Evolution of (sub) surface water properties in the Nordic Seas since the Last Glacial Maximum	Jiali Hong	Tongji University, China
S29-P08-A3461	Size-dependent $\delta^{18}\text{O}$ and $\delta^{13}\text{C}$ variations in a planktic foraminiferal <i>Neogloboquadrina pachyderma</i> (sinistral) record from Chukchi Plateau: implications for (sub) surface water conditions in the western Arctic Ocean over the past ~50 ka	Rujian Wang	Tongji University, China
S29-P09-A4355*	Distribution patterns of coarse-grain clasts in the western Arctic Ocean surface Sediments: implications for their provenances and transportation pathways	Taoliang Zhang	Tongji University, China

ID	Title	Author	Affiliation
S30-P01-A0065	East China Sea Rifting and Volcanism	Deniz Cukur	Korea Institute of Geoscience and Mineral Resources
S30-P02-A0141	Indian summer monsoon variability during the past 6,000 years	Saravanan P	Indian Institute of Technology Kharagpur, India
S30-P03-A0315	Petrophysical characteristics and correlation of volcanic and volcanoclastic rocks at IODP Site U1513, Expedition 369, offshore SW Australia	Eun Young Lee	Chonnam National University, Korea
S30-P04-A1615	Palaeoclimatic reconstruction of East Asia deduced from provenance changes of detrital material based on ESR signal intensity of quartz	Ke Wang	The University of Tokyo



POSTER Session

S32

ID	Title	Author	Affiliation
S32-P01-A0097*	Effects of igneous bodies on modification of modern slope morphology: Insights from the continental slope offshore Dongsha Islands, South China Sea	Chao Liang	China Univerisity of Geosciences, Wuhan
S32-P02-A0463*	Mineralogical characteristics of Larsen ice shelf regions, Antarctic Peninsula	Jaewoo Jung	Yonsei University, Korea
S32-P03-A0534	Review of Late Pleistocene-Holocene Sequence stratigraphy on the southern Vietnam Shelf	Trung Thanh Nguyen	Institute of Marine Geology and Geophysics, Vietnam
S32-P04-A0548	Geo-Cultural Heritage Conservation For Sustainable Geo-Tourism : Management of Marine Caves in India	Kalpna Chaudhari	Institute For Sustainable Development and Research, India
S32-P05-A0954	Riverine supplies to eastern Mediterranean during the last interglacial sapropel event – A basin-wide perspective	Jiawang Wu	Tongji University, China
S32-P06-A1133	Periodic marine incursion and the interruption of Neolithic dwelling in the southeast Yangtze coastal plain during the middle Holocene	Zhanghua Wang	East China Normal University, China
S32-P07-A1460	Evolution and characteristics of Late Oligocene-Miocene shallow water carbonates in the southern continental margin of the South China Sea	Yuantao Liao	China University of Geosciences, China
S32-P08-A1765	Dimorphism of <i>Bicornucythere bisanensis</i> in the East China Sea and its implication for speciation through paedomorphosis	Yunan Wang	Shanghai Natural History Museum, China
S32-P09-A1846*	Development of a modern calibration between the chemical composition of marine shells and environmental parameters in coastal marine waters	Maximiliano Rodriguez	The University of Hong Kong, Hongkong, China

POSTER Session

S32

ID	Title	Author	Affiliation
S32-P10-A2115	Geomorphology and Quaternary sedimentary characteristics around large isolated carbonate platforms in the Xisha (Paracel) Archipelago, South China Sea	Benjun Ma	Institute of Deep-sea Science and Engineering, Chinese Academy of Sciences, China
S32-P11-A2463*	Sustainable groundwater resources in Precambrian basement aquifers of Aravalli terrane, North Gujarat, India: a structural approach	Rudra Mohan Pradhan	Indian Institute of Technology Bombay, India
S32-P12-A3296	Architecture and controlling factors of the Miocene carbonate platforms in Bekang Basin, southern South China Sea	Wei Yan	Key Laboratory of Marine Mineral Resources, China
S32-P13-A3500*	Geochemistry indicates human activities intensively altered the natural sediment routing processes in the Huanghe (Yellow River)	Yulong Guo	Tongji University, China
S32-P14-A3507*	Reconstruction of Tectonic-lithofacies Palaeogeography of the late Sinian Dengying Formation in the Yangtze Craton	Xiaofeng Zhou	Tongji University, China
S32-P15-A3765	Mid-Holocene hydrology change in the south Taihu area of the Yangtze delta plain, China, and its relationship to the development of Neolithic cultures	Zhanghua Wang	East China Normal University, China
S32-P16-A3912	The stable water isotopes over the marginal china seas	Ergang Lian	Tongji University, China
S32-P17-A3919*	When did coccolithophores bloom during the late Pleistocene?	Hongrui Zhang	Tongji University, China; ETH Zurich, Switzerland
S32-P18-A4756*	Paleoproductivity Records in South China Sea during the Late Miocene	Chuanlian Liu	Tongji University, China



ID	Title	Author	Affiliation
S32-P19-A4911	Tectonic evolution of the Costa Rica convergent margin: insights from new paleomagnetic results of the IODP Expedition 344 cores	Yongxiang Li	Nanjing University, China
S32-P20-A5175*	Bioturbated carbonate reservoir heterogeneity: A case study from Cretaceous K2 Zone, A Oilfield, Iraq	Yingchu Shen	Peking University, China
S32-P21-A5339	Seasonal Distribution of Modern Foraminifera in the South China Sea: Plankton Tow and Sediment Trap Records at SEATS	Hui-Ling Lin	National Sun Yat-Sen University, Taiwan, China

POSTER Session

W01

ID	Title	Author	Affiliation
W01-P01-A0734	Preliminary experiment on gas hydrate exploitation using a large scale gas hydrate production experimental simulation device	Changling Liu	Qingdao Institute of Marine Geology, China
W01-P02-A0971	Evaluate the Relationship between Sediment Physical Properties and Hydrate Production Efficiency in South China Sea	Qiang Chen	Qingdao Institute of Marine Geology, China
W01-P03-A2135	Study of the surface morphology of gas hydrate using cryo-SEM	Jianye Sun	Qingdao Institute of Marine Geology, China
W01-P04-A2288	Methane Flux Effect on Hydrate Formation and its Acoustic Responses in Natural Sands	Qingtao Bu	Qingdao Institute of Marine Geology, China
W01-P05-A2744	Laboratory Analytical Strategy of Hydrate-Bearing Cores from both Marine and Terrestrial Regions in China	Qingguo Meng	Qingdao Institute of Marine Geology, China
W01-P06-A2908*	Investigation on the multi-parameter of hydrate-bearing sands using nano-focus X-ray computed tomography	Chengfeng Li	Qingdao Institute of Marine Geology, China
W01-P07-A3866	Geomorphological-geological-geophysical signatures of high-flux fluid flows in the eastern Pearl River Mouth Basin and effects on gas hydrate accumulation	Fang Liu	Ocean University of China
W01-P08-A3910	Occurrence and control factors of the active cold seepages in the western sea area of the Pearl River Mouth Basin, South China Sea	Chengzhi Yang	Guangzhou Marine Geological Survey, China
W01-P09-A4090	Numerical simulation of gas hydrate formation rate in Shenhu sea area	Yunxin Fang	Shanghai Ocean University, China
W01-P10-A5050	A fractal theory based permeability model of hydrate-bearing sediments	Zhun Zhang	Qingdao Institute of Marine Geology, China



POSTER Session

W02

ID	Title	Author	Affiliation
W02-P01-A3299	The distribution of trace metal in the south China sea	Lin Sun	Hamburger University, Germany
W02-P02-A4906	Response of Sinking Biogenic Fluxes to Monsoon, Eddy and Dust Events in the Northwestern South China Sea	Jingjing Zhang	Second Institute of Oceanography, China
W02-P03-A4991	Asymmetric response of sinking biogenic flux to ENSO oscillation in the central South China Sea	Hongliang Li	Second Institute of Oceanography, China
W02-P04-A5349	Dinoflagellate cysts in the surface sediment of Van Phong Bay, Khanh Hoa province	Tan Luom Phan	Graduate University of Science and Technology, VAST, Vietnam

W03

W03-P01-A0993*	Late Pleistocene-Holocene Stratigraphy and Depositional History in the Jeju Strait, Korea	Bo-Ram Lee	Korea Institute of Geoscience and Mineral Resources
W03-P02-A1123*	Sedimentary facies and depositional processes of the Postglacial incised-valley fills beneath a wave-dominated coast, Kujukuri Plain, central Japan	Junko Komatsubara	Geological Survey of Japan, AIST
W03-P02-A1491	Ocean bottom gravity surveys in the transition zones along the Japanese Islands	Shigeo Okuma	Geological Survey of Japan, AIST



All 565 pages printed in color
Price: ¥158

Earth System and its Evolution

WANG Pinxian et al.



Prof. WANG Pinxian

The 565-page textbook on Earth System Science is designed for research students as a shortcut channel to the frontiers in Earth sciences. The 12 chapters of the book is written on the basis of over thousand references from the world literature. The first 5 chapters introduce to the Earth's spheres, that are interconnected through water and carbon cycles, followed by another 5 chapters overviewing the evolution and variabilities of the Earth system on a variety of timescales, before completed with the last 2 chapters devoted to research methods and theories of the Earth system, respectively. With 298 color figures and 45 inserted text-boxes, the book provides a guide in simple language to the interactions between Earth's sub-systems, i.e. the atmosphere, hydrosphere, biosphere, lithosphere and mantle. To improve the text-book function, each chapter is attached with a summary and review questions, written on the basis of 20 years of teaching practice by Prof. WANG Pinxian and his colleagues.

This book is published by China Science Publishing&Media Ltd in June 2018. The inside pages of the book are printed on coated paper in full color.

Contents:

- | | |
|--|--|
| Chap. 1 Composition and Origin of the Earth System | Chap. 7 Evolution on Orbital Timescale |
| Chap. 2 Earth Surface System and Mantle | Chap. 8 Cyclicity Transfers and Abrupt Changes in Climate |
| Chap. 3 Hydrological Cycle in the Earth System | Chap. 9 Environment changes on Human Dimension |
| Chap. 4 Carbon Cycle of the Earth system | Chap. 10 Global Change and Paleoenvironmental Studies |
| Chap. 5 Biosphere and its Evolution | Chap. 11 Quantitative Approaches to Earth Surface System |
| Chap. 6 Evolution on Tectonic Timescale | Chap. 12 Searching for Operational Mechanism of Earth System |



Scan the QR code
chatting with the authors

Executive editors: HAN Peng, MENG Meicen

Tel: 010-64011160 010-64034012

E-mail: mengmeicen@mail.sciencep.com

earthscience@mail.sciencep.com

Address: Science Press, 16 Donghuangchenggen North Street, Beijing



Scan the QR code
for buying

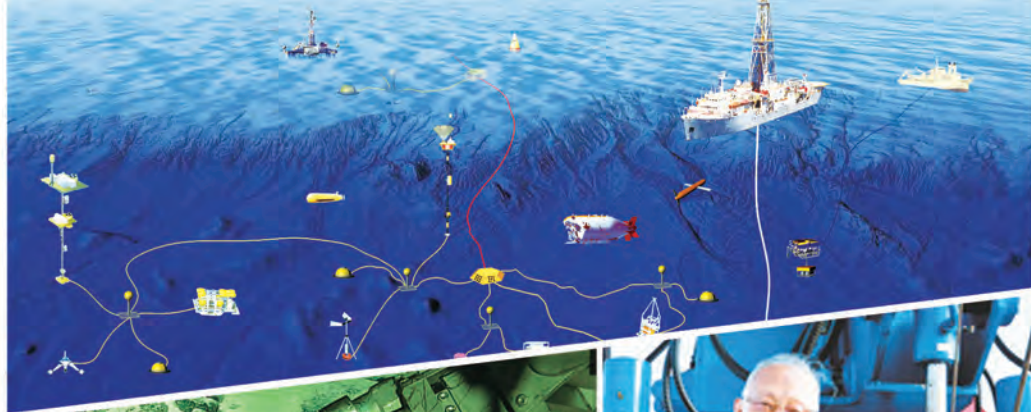

1733.9085N, 11744.8633E, 3518
 04-25-2018 04:45:57 H
 TTK 2018

WELCOME TO JOIN US!

School of Ocean and
 Earth Science
 Tongji University



State Key Laboratory of
 Marine Geology
 Tongji University



★ Introduction

The State Key Laboratory of Marine Geology at Tongji University was established in 2006 with the endorsement from the Ministry of Science and Technology of China (MOST). Its main research areas are Paleoceanography and Paleoenvironment, Marine Sedimentology, Oceanic Lithosphere Evolution, Submarine Resources and Geophysics, Marine Biogeochemistry, Seafloor Process and Observation. The Goal of the Laboratory is to investigate environmental change and natural resources in global oceans and neighboring continental regions, with a strong focus on basic research in Asian marginal seas. By actively involving in ocean drilling and observatories, and other large international research programs, the Laboratory is committed to understanding the comprehensive earth system science and the interaction between ocean and Earth's other spheres at various spatial and temporal scales.

School of Ocean and Earth Science State Key Laboratory of Marine Geology Tongji University



Global Recruitment

Contact Person: Ms. CHEN

Phone: 0086 21 65983790

Email: cys@tongji.edu.cn

Website: <http://mgg.tongji.edu.cn>

<http://mlab.tongji.edu.cn>



IODP-CHINA Scientific Committee



State Key Laboratory of Marine
Geology, Tongji University

IODP-CHINA
STARTED FROM SOUTH CHINA SEA...

20th ANNIVERSARY IODP-CHINA 1998-2018

YOU ARE INVITED TO VISIT
THE 20TH ANNIVERSARY EXHIBITION OF
INTERNATIONAL OCEAN DISCOVERY PROGRAM-CHINA
AT THE EXHIBITION HALL IN ZHONGHE BUILDING.

IODP 368 (2017)
IODP 367 (2017)
IODP 349 (2014)
ODP 184 (1999)

The IODP-China Office
State key Laboratory of Marine Geology,
Tongji University
1239 Siping Road, Shanghai 200092, China
Tel. +86-21-6598 3441
Fax +86-21-65988808
E-mail iodp_china@mail.tongji.edu.cn
Website www.iodp-china.org





中山大学海洋科学学院

SCHOOL OF MARINE SCIENCES, SYSU

Introduction

Established in 2008, School of Marine Sciences is located along the coast of beautiful Zhuhai. With good academic atmosphere and comfortable research environment, School of Marine Sciences has its own features and advantages in Marine Biological Resources and Deep-Sea Biology, Marine Power and Substances Transport Process, Marine Environment and Ecological Dynamic Process, and Marine Mineralization and Accumulation Mechanism and Exploration, building a talent training system including marine science for undergraduate program, master degree programs in first-level disciplines and post-doctoral program. The overall assessment of first-level disciplines ranked fourth in the third round of China University Subject Rankings(CUSR) held by the Ministry of Education evaluation, and ranked third in the fourth round of CUSR.

School of Marine Sciences has over 120 faculties, including 26 professors and researchers, 61 associate professors and deputy researchers. There are 3 national Distinguished Young Scholars, 3 New Century Excellent Talents funded by Ministry of Education, 2 national Excellent Young Scholars, 1 Pearl River Scholar of Guangdong Province, 2 Excellent Youth of

Guangdong Province, and 4 Pearl River New Star of Science and Technology. Supported by 390 million research funds, we have established 12 national, provincial and ministerial-level innovation platforms, hosted and participated over 140 national-level scientific research projects, published more than 750 papers, in which 400 were included in SCI, and obtained or applied for more than 100 patents.

Under the background of national strategy to accelerate the implementation of building a "Maritime Power", rooted in the South China Sea and embracing seas and oceans, Sun Yat-sen University re-adjusted its academic layout in 2015, and decided to build over ten schools or disciplines based on ocean in Zhuhai campus. Supported by "Tianhe-2" supercomputer, 6,000 tons of marine scientific research vessels (built) and a large number of large-scale infrastructure facilities such as School of Marine Sciences Building, which is over 60,000 square meters, School of Marine Sciences will attract high level scientists worldwide, strengthen the training of technical personnel, enhance our core technology, and build an internationally well-known and domestic leading marine science discipline.

Disciplines

- Marine Power and Substances Transport Process
- Marine Biological Resources and Deep-Sea Biology
- Marine Environment and Ecological Dynamic Process
- Marine Mineralization and Accumulation Mechanism and Exploration

Scientific Platforms

- South China Sea Marine Biotechnology National Engineering Research Center
- China-ASEAN Center for Joint Research and Promotion of Marine Aquaculture Technology
- Hekou Water Conservancy Technology National Joint Engineering Center
- National Marine Natural Product Compound Library
- Guangdong South China Sea Resources Development and Protection of Collaborative Innovation Center
- Guangdong Key Laboratory of Marine Resources and Nearshore Engineering
- Guangdong Coast and Island Reef Engineering Technology Research Center
- Guangdong Hekou Water Conservancy Engineering Laboratory
- Key Laboratory of Offshore Oil Exploration and Development in Guangdong Province
- Key Laboratory of Marine Microbial Functional Molecules in Guangdong Province
- Key Laboratory of Marine Biological Resources and Environment of Zhuhai
- Zhuhai South China Sea Resources Development and Protection Collaborative Innovation Center



JAMSTEC

Japan Agency for Marine-Earth Science and Technology

Fleet

The Earth is unique in the solar system as the only planet blessed with liquid oceans of water on its surface. The Japan Agency for Marine-Earth Science and Technology (JAMSTEC) aims to better understand the roles played by the oceans in the Earth system, as part of an integrated investigative approach of the complex interactions among and between the ocean, the Earth, life, and human activities. We promote innovation related to marine resource utilization, marine biotechnological progress, and more advanced marine-earth data and information services. JAMSTEC is committed to promoting the most advanced research and technological development projects, not just for Japan, but globally.

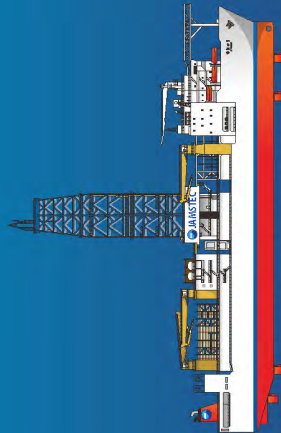

Deep-sea Scientific Drilling Vessel

Chikyu



Deep-Sea Research Vessel

Kairei



Research Vessel

Kaimei



Research Vessel

Hakuohmaru



Oceanographic
Research Vessel

Mirai



Support Vessel

Yokosuka



Research Vessel

Shinsei maru

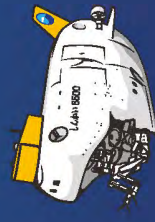

Manned Research Submersible

Shinkai 6500



Remotely Operated
Vehicle

Kaiko



Autonomous Underwater Vehicle

Urashima



Autonomous
Underwater Vehicle

Jinbei



Remotely Operated Vehicle

Hyper-Dolphin



Autonomous
Underwater Vehicle

Otohime

Deep Ocean Floor
Survey System

Deep Tow



Autonomous
Underwater Vehicle

Yumeiruka

Discover a new world of mass spectrometry

Discover the isotopic anatomy of molecules

Get direct access to conditions molecules were formed, how they were transported, stored and degraded. The new Thermo Scientific® 253 Ultra high resolution isotope ratio mass spectrometer revolutionizes the field of site specific and clumped isotope ratio analysis of molecules in paleoclimatology, atmospheric science, biogeochemistry, petrology and many other applications.



253 Ultra
high resolution isotope ratio MS

Find out more at thermofisher.com/253Ultra

高质量的测试结果 经得住时间的考验



欢迎莅临BETA展位

— 始于1979 —
精准快速，始终如一



Beta Analytic
www.radiocarbon.cn

欢迎莅临BETA美实验室01号展位咨询，有机会取得精美纪念品



微区X射线荧光成像光谱仪 - M4 TORNADO

M4 TORNADO 特点

微区X射线荧光光谱分析技术是对不均匀样品、不规则样品、甚至小件样品室可以放置各种尺寸的样品和包裹物进行高灵敏度的、非破坏性的元素分析的首选方法。采用多导毛细管聚焦镜将激发光聚焦到非常小的区域,以获得极佳的空间分辨率,进行快速分析。任何类型的样品都可以通过简单的样品制备甚至不制备直接进行分析。

地质行业应用:

1、地质薄片应用 2、陨石应用 3、沉积学岩心应用 4、石榴石应用

常见行业应用:

1、地球科学 2、材料科学 3、质量控制与故障分析 4、发动部件、电机/润滑油
5、司法鉴定 6、科技考古学 7、生物科学



瑞典Itrax XRF岩芯扫描分析仪

——是和海洋、湖底沉积物样芯, 钻探岩石岩心样品及其他树木, 柱状样品的快速XRF元素分析及X光射线成像扫描和高清晰光学扫描

瑞典Cox Analytical System公司与英国Southampton Oceanographic Centre (南安普敦海洋中心) 合作开发的Itrax沉积物岩芯扫描分析仪(又称Itrax岩芯密度与元素分析系统、Itrax岩芯XRF扫描仪等)结合了微观X射线荧光分析(X-ray Fluorescence)、数字X射线成像(digital x-ray micro radio-graphy)和光学成像三种技术,用于沉积物样柱(样芯)的非接触式扫描分析,提供高质量、高精度数据,不破坏样品,保持样品的原始性和完整性。

应用:

• 海洋(湖泊、河口、冰河)沉积物样芯(样柱) • 海洋沉积与古环境
• 湖泊沉积与环境 • 黄土沉积物研究 • 古气候学、过去全球变化



布鲁克手持式XRF分析仪 S1 TITAN

● **采矿和勘探** Bruke S1 TITAN采矿分析仪是一款运行快速,测量精准且操作简单的手持式XRF,其应用涵盖了采矿作业的所有领域,并提供整体解决方案。此款分析仪可对矿层表面和钻孔岩心进行现场地址化学分析,且仅需几分钟时间就可以达到传统实验室分析需要数天才能得到的分析结果,可大大提高生产效率。不仅如此,采用S1 TITAN进行实时勘测,可以快速确定矿体边界,识别具有最高潜在价值的区域,现场使用制备好的标样更能进一步提高精度。

优点 • 现场地质化学分析 • GPS/绘图 • 快速、准确、便于使用 • 坚固耐用,防尘防水设计(IP54) • 可测量多达45种元素,包括镁、铝、硅、磷和硫
• TITAN防扎探测器 • 选配桌面或台面支架



GROUND TRANSPORTATION

There are two international airports in Shanghai, the Pudong International Airport (airport code PVG) and the Hongqiao International Airport (airport code SHA). Please be aware at which airport you will be landing. You can reach the Tongji University from the airports by taxi, Maglev (high-speed magnetic levitation line, for PVG only), or metro (subway), or their combinations.

From the Pudong International Airport (PVG):

1. Taxi (recommend if you have large luggage and/or arrive at evening): Please take a taxi at the airport directly to the hotel. It takes about 50 minutes and costs about 160 yuan (RMB).
2. Maglev + taxi: Take the Maglev at the Pudong Airport, get off the Maglev at the Longyang Station (terminal of Maglev). Then, take a taxi to the hotel. Ticket of Maglev: 40 yuan each by showing your flight ticket or boarding pass. Taxi costs about 60 yuan.
3. Maglev + Metros: This is a cheaper but more complicated choice. Take Maglev at the Pudong Airport, transit to Metro Line 2 at the Longyang Station (terminal of Maglev), then change to Metro Line 10 at the “East Nanjing Road” Station, and get off at the “Tongji University” Station. It costs ~50 Yuan for this option.
4. Metros only: Take Metro Line 2 at the Pudong Airport, transit to Metro Line 10 at the “East Nanjing Road” Station, and get off at the “Tongji University” Station. It costs only ~10 Yuan for this option but you need ~2 hr to get to the campus.

From the Hongqiao International Airport (SHA):

1. Taxi: It takes you about 40 minutes and costs ~100 yuan. There are also Airport buses, but none of those comes close to Tongji.
2. Metro (recommended): Take Metro Line 10 at the Hongqiao Airport, and get off at the “Tongji University” Station. It costs ~6 Yuan and takes ~1.0 hr to get to the hotel.

Shanghai City

Traffic Map



Note: There are Shanghai Maps at <http://www.chinatouristmaps.com/city/shanghai.html> for foreigners to make their tourism in Shanghai easier.

Tongji University

Campus Map

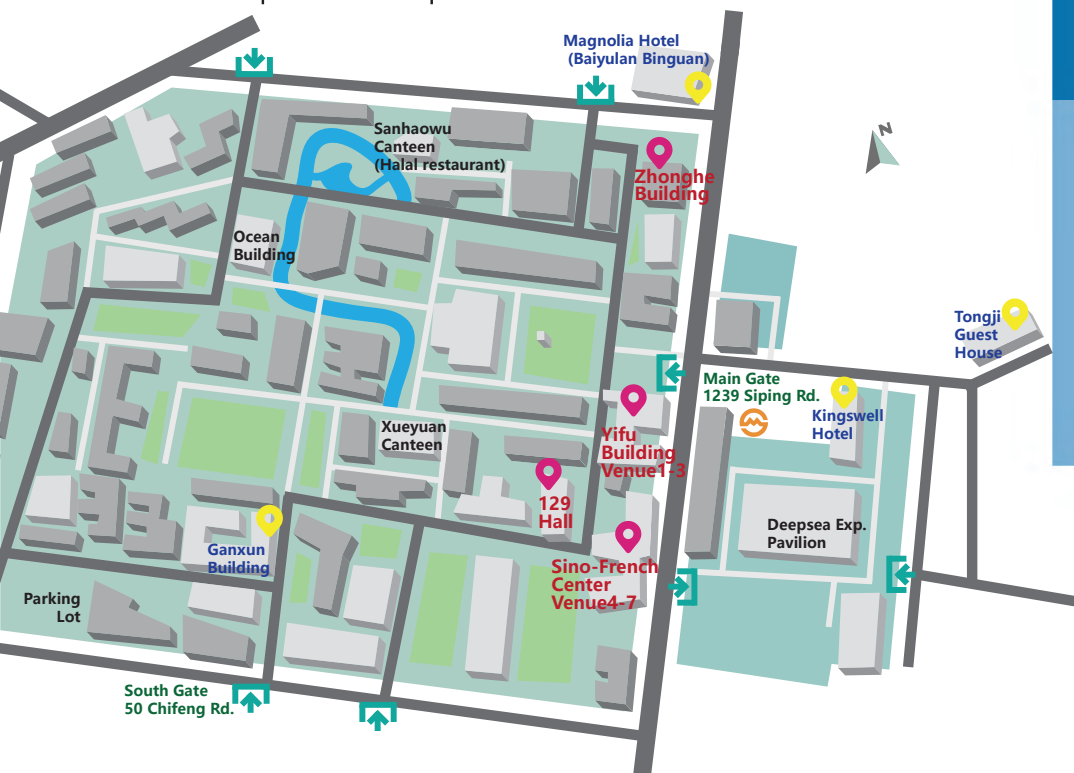

-  **Venue 1** Yifu Building 1st floor meeting room
- Venue 2** Yifu Building Room 113
- Venue 3** Yifu Building Lecture Hall
- Venue 4** Sino-French Center C401
- Venue 5** Sino-French Center C501
- Venue 6** Sino-French Center C301
- Venue 7** Sino-French Center C201

 Accommodations

Halal restaurant located in Sanhaowu Canteen 1st floor
 Parking Lot on campus, 200 Chifeng Rd.

Exhibition Hall

Zhonghe Building
- Ground Floor

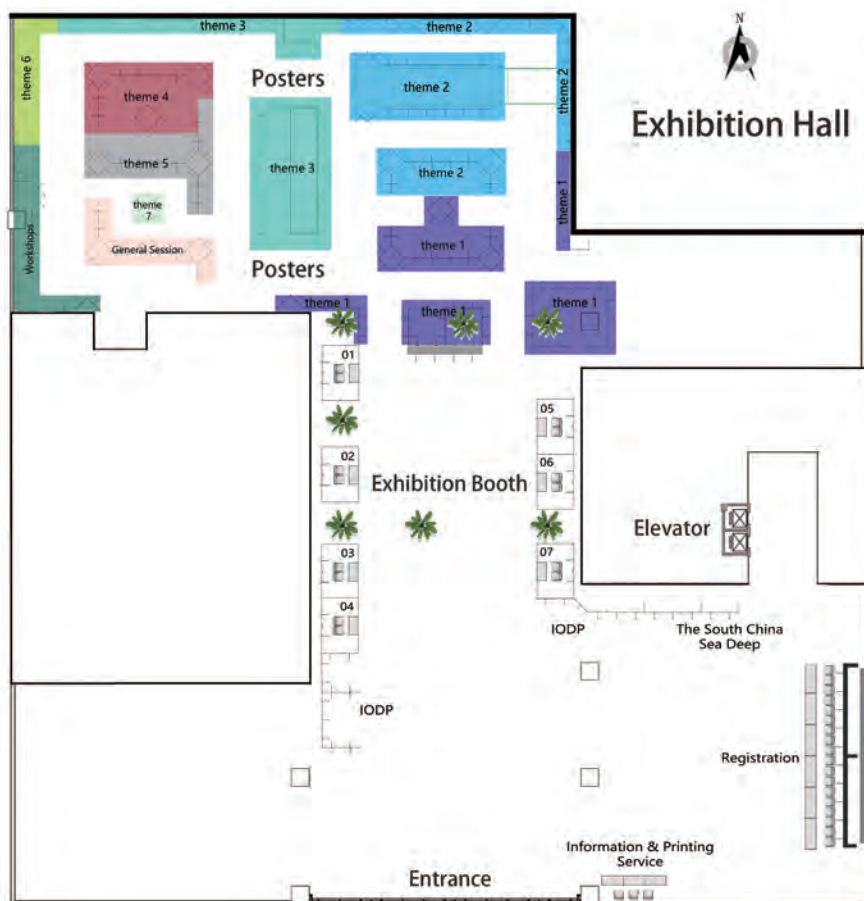

MARINE GEOSCIENCE IN *RISING ASIA

ICAMG-9

ADDRESS

State Key Laboratory of Marine Geology
Tongji University, Shanghai 200092, China

- TEL. 86-21-6598 5090
- E-MAIL icamg-9@tongji.edu.cn
- Website icamg-9.tongji.edu.cn

